

Single Stage Parallel Shaft Reduction (Stand-Alone or Prefix for other SS Product Families)

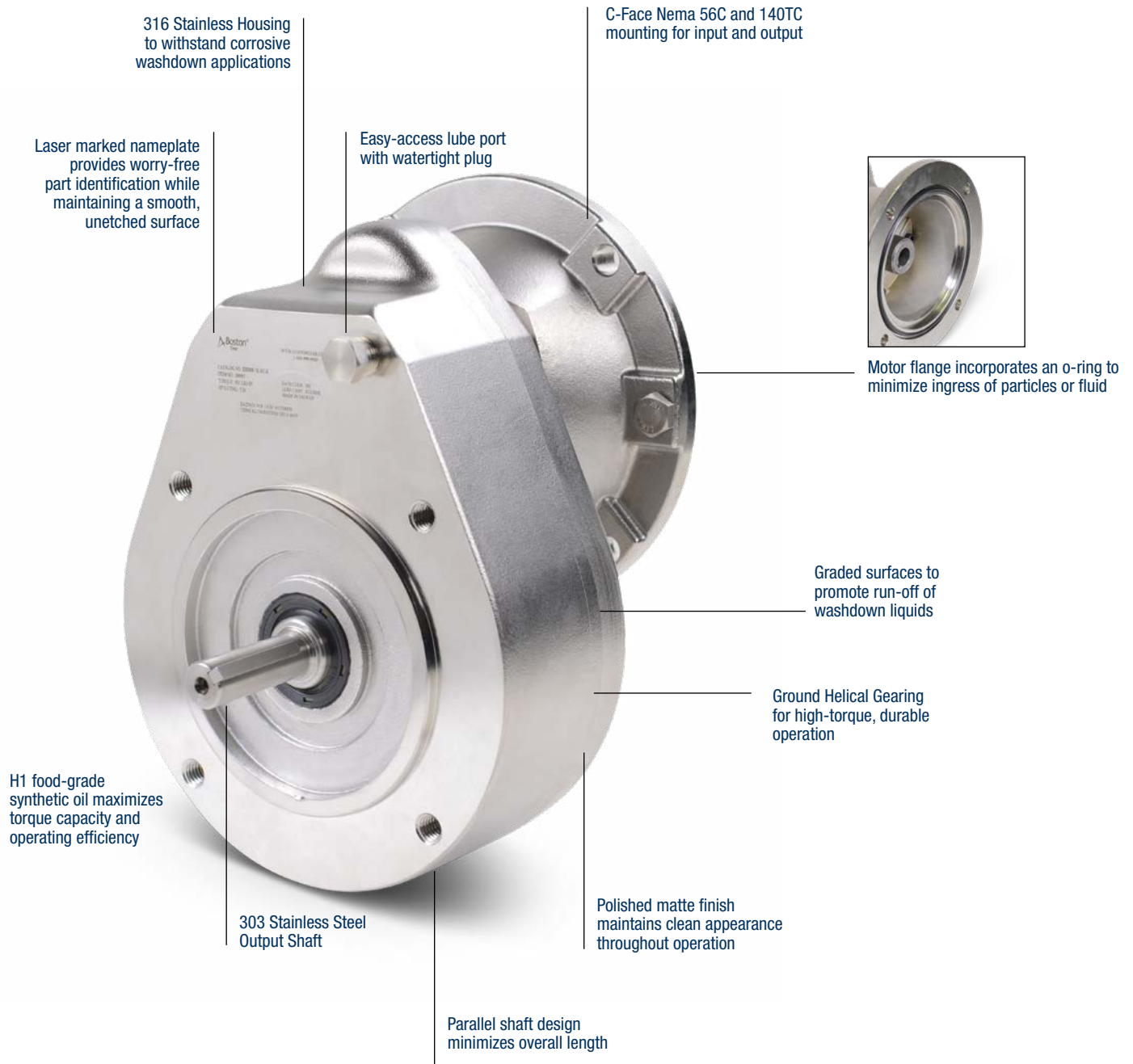

B2 SSHMF Series Helical Multiplier

Ordering Information

Stainless Steel Stand-Alone Helical Multiplier

Example: SSHMF2-1.5K-B5-B5

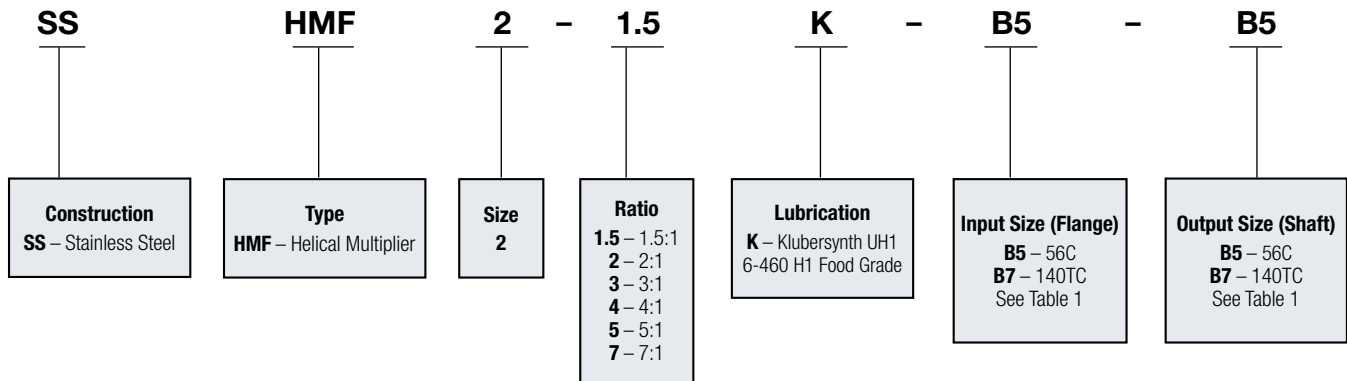

Table 1: Available Ratio-Input-Output Combinations

Ratio	Input	Output
1.5	B5	B5
2	B5	B5
	B7	B7
3	B5	B5
4	B5	B5
5	B5	B5
	B7	B7
7	B5	B5

Lubrication

All SSHMF Helical Multipliers are supplied as Lubricated for Life for maximum efficiency, maintenance-free operation. The small cavity design offers the ideal mix of heat dissipation and lubrication contact in all mounting configurations. Normal full load operating temperatures range between 130°F and 150°F. Recommendations are based on input speed of 1800 RPM nominal. For higher input speeds, consult factory.

RECOMMENDED LUBRICANT	Reducer Designation	ISO Viscosity Grade No.	Viscosity Range SUS @ 100F	Part Number (Quart)	Comments
Klubersynth UH1 6-460 Synthetic	K	460	1950/2500	65159	H1 Food-Grade

Ambient temperature range of -20°F to +125°F is suitable for standard configured products and ratings. Contact technical support for operating conditions beyond this range. Notes: Upper temperature limit is dictated by reducer components and not the oil.

Performance Data

Size	Output RPM	Ratio	Motor HP (1750 RPM Input)	Output		Output Shaft Loading (lbs)		
				HP	Torque (lb.ins)	Thrust	Overhung Load (B5 Output)	Overhung Load (B7 Output)
SSHMF2	1167	1.5	13.60	13.19	712	230	375	750
	875	2	11.76	11.41	822	253	375	750
	583	3	9.48	9.20	944	289	375	750
	438	4	7.27	7.06	914	317	375	750
	350	5	5.06	4.91	884	345	375	750
	250	7	1.55	1.46	365	358	375	750

Ratings shown reflect maximum gear capacity based on AGMA standards (service factor = 1.0) with Klubersynth UH1 6-460. Overhung Load is measured at the centerline of the output shaft projection and ratings are based on no thrust load applied. Ratings based on input speed of 1750 rpm.

Dimensions

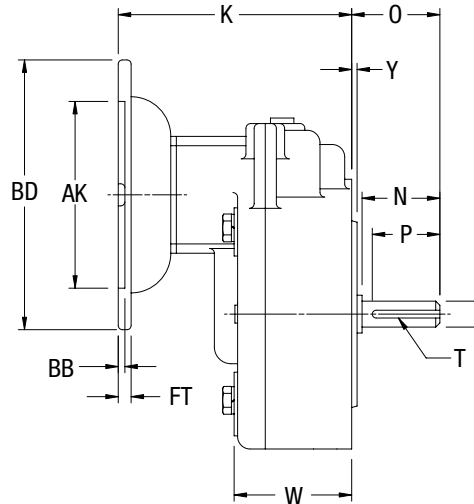
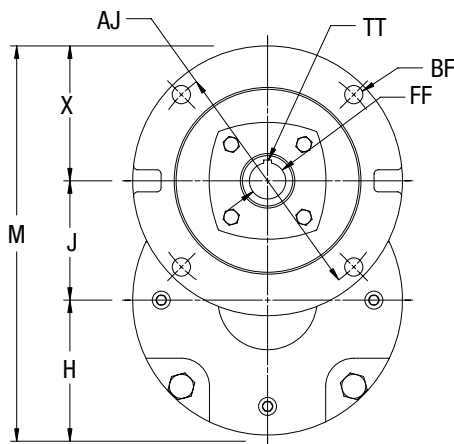

Dimensions in Inches

Size	Output Size (Shaft)	F	H	J	K	M	N	O	P	T	W	X	Y
SSHMF2	B5	0.625	3.37	2.875	5	9.49	1.84	1.9	1.57	3/16X3/32	3	3.25	0.16
	B7	0.875	3.37	2.875	5	9.49	1.84	1.9	1.57	3/16X3/32	3	3.25	0.16

Size	Input Size (Flange)	AJ	AK	BD	BF	BB	FF	FT	TT
SSHMF2	B5	5.875	4.5	6.5	0.41	0.16	0.625	0.43	3/16X3/32
	B7	5.875	4.5	6.5	0.41	0.16	0.875	0.43	3/16X3/32

