

**Model
HC/CH
Clutch
For
Marine
Applications**





THE MODEL HC/CH CLUTCH IS A DROP-IN REPLACEMENT TO COMPETITIVE UNITS INCLUDING CH-1050, 1250, 1440 AND 1640 CLUTCHES.

HC/CH clutches are ideal for use in marine applications including drawworks, winches, and propulsion.

The HC/CH clutch, with the EWA/EDA provision, is available in two styles. The EWA model is designed to run in an oil immersed application while the EDA units are designed to run as dry friction clutches.

Both styles incorporate the high quality construction and performance of the Wichita/Industrial Clutch standard Model HC clutch including:

- Forced oil cooling provisions for high energy engagements.
- Hubs are manufactured from high quality alloy steel and include induction hardened teeth for maximum spline life.
- Disc Pac cores are designed using extra heavy plate thicknesses to maximize torque and heat capacity while minimizing spline wear to both the disc cores and hub.
- Friction materials for both wet and dry applications are designed to provide high thermal and smooth engagement performance.
- Wet friction material used in the EWA style oil immersed units allows for the use of both **EP (extended pressure) and vegetable based oils**. Due to increased environmental regulations, this capability is fast becoming a must for ship and rig operators worldwide.

INNOVATIVE PERFORMANCE AND INSTALLATION ADVANTAGES

There are several features that separate the EWA and EDA style HC clutches from competitive counterparts. Some models include the extra wide disc cores and the ability to use a variety of lubrication oils as stated above.

Most unique to this HC/CH clutch is the incorporation of the **Patent Pending Key Seal**. This innovation allows for the use of standard O-rings and improves the ease of installation in current configurations using a double keyway and single drilled actuation hole. This feature simplifies the sealing process and minimizes the possibility of damage to expensive seal arrangements. If seal damage with the Key Seal feature does occur, the seals can be repaired easily without the need to remove the clutch from the shaft in most applications.



HC/CH clutches feature extra thick plates combined with high performance friction materials.



HC/CH clutches installed in drawworks gearbox.

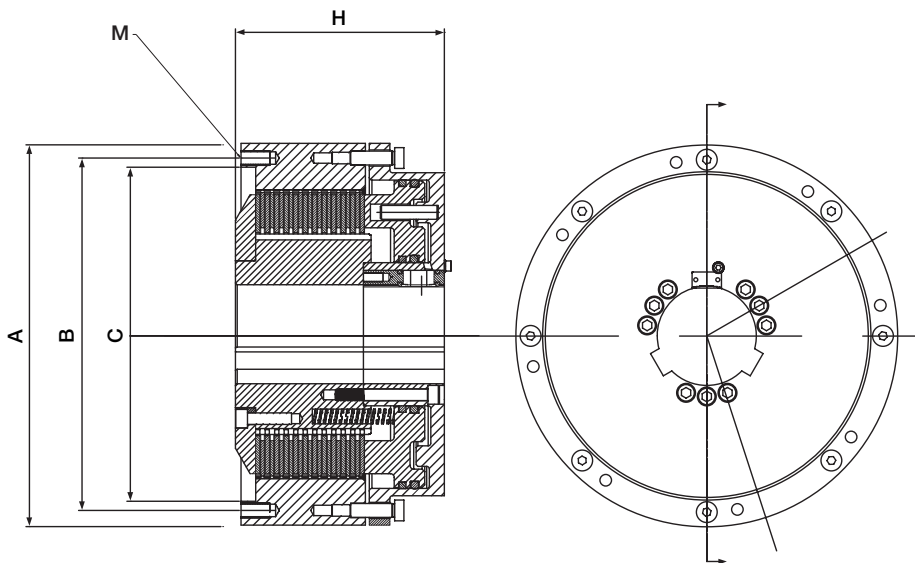

Dimensions

MODEL	A mm (in.)	B mm (in.)	C mm (in.)	H mm (in.)	M size x no.
HC-10-11-EWA HC-10-9-EDA	330 (13.00)	304.8 (12.000)	288.9 (11.375)	181 (7.13)	1/2-13 X 12
HC-12-11-EWA HC-12-9-EDA	394 (15.50)	365.1 (14.375)	345 (13.583)	203 (8.00)	1/2-13 X 15
HC-13-12-EWA HC-13-10-EDA	451 (17.75)	419.1 (16.500)	396.9 (15.625)	238 (9.38)	5/8-11 X 15
HC-15-11-EWA HC-15-10-EDA	502 (19.75)	469.9 (18.500)	446.1 (17.562)	244 (9.98)	5/8-11 X 18

Specifications

MODEL	STATIC TORQUE		MAX. RPM	WGT INNER kg. (lbs.)	WGT OUTER kg. (lbs.)	WR2 INNER kgm ² (lb.ft. ²)	WR2 OUTER kgm ² (lb.ft. ²)
	Nm	(lb.in.)					
HC-10-11-EWA HC-10-9-EDA	14690 14690	(130000) (130000)	2200 2200	46 (101.4)	25.8 (56.9)	0.449 (10.65)	0.564 (13.38)
HC-12-11-EWA HC-12-9-EDA	25430 25430	(224200) (224200)	2000 2000	90.22 (198.9)	41.55 (91.6)	1.364 (32.37)	1.218 (28.90)
HC-13-12-EWA HC-13-10-EDA	38200 42380	(338000) (375000)	1800 1800	128.16 (282.5)	74.56 (164.4)	2.515 (59.68)	2.828 (67.11)
HC-15-10-EWA HC-15-10-EDA	55130 58200	(488000) (515000)	1600 1600	150.6 (332.0)	103.8 (228.8)	3.667 (87.02)	4.779 (113.41)

Static Torque for EWA units is based on 10.5 bar (150 psig)
 Static Torque for EDA units is based on 5.0 bar (75 psig)

Wichita Clutch Facilities

North America

USA

2800 Fisher Road
Wichita Falls, TX 76302 - USA
940-723-3400

*Pneumatic Clutches
and Brakes*

Europe

United Kingdom

Amphill Road
Bedford MK42 9RD - England
+44 (0) 1234 350311

*Pneumatic Clutches
and Brakes*

Asia Pacific

Australia

+61 2 9894 0133

China

+86 21 5169-9255

Hong Kong

+852 2615 9313

Singapore

+65 6487 4464

Taiwan

+886 2 2577 8156

Thailand

+66 2322 5527

The Brands of Altra Industrial Motion

Couplings

Ameridrives
www.ameridrives.com

Bibby Turboflex
www.bibbyturboflex.com

Guardian Couplings
www.guardiancouplings.com

Huco
www.huco.com

Lamiflex Couplings
www.lamiflexcouplings.com

Stromag
www.stromag.com

TB Wood's
www.tbwoods.com

Gear Cam Limit Switches

Stromag
www.stromag.com

Electric Clutches & Brakes

Inertia Dynamics
www.idicb.com

Matrix
www.matrix-international.com

Stromag
www.stromag.com

Warner Electric
www.warnerelectric.com

Linear Products

Warner Linear
www.warnerlinear.com

Engineered Bearing Assemblies

Kilian
www.kilianbearings.com

Heavy Duty Clutches & Brakes

Industrial Clutch
www.indclutch.com

Twiflex
www.twiflex.com

Stromag
www.stromag.com

Svendborg Brakes
www.svendborg-brakes.com

Wichita Clutch
www.wichitaclutch.com

Belted Drives

TB Wood's
www.tbwoods.com

Gearing

Bauer Gear Motor
www.bauergears.com

Boston Gear
www.bostongear.com

Delroyd Worm Gear
www.delroyd.com

Nuttall Gear
www.nuttallgear.com

Overrunning Clutches

Formsprag Clutch
www.formsprag.com

Marland Clutch
www.marland.com

Stieber
www.stieberclutch.com

Neither the accuracy nor completeness of the information contained in this publication is guaranteed by the company and may be subject to change in its sole discretion. The operating and performance characteristics of these products may vary depending on the application, installation, operating conditions and environmental factors. The company's terms and conditions of sale can be viewed at <http://www.altramotion.com/terms-and-conditions/sales-terms-and-conditions>. These terms and conditions apply to any person who may buy, acquire or use a product referred to herein, including any person who buys from a licensed distributor of these branded products.

©2018 by Wichita Clutch LLC. All rights reserved. All trademarks in this publication are the sole and exclusive property of Wichita Clutch LLC or one of its affiliated companies.



www.wichitaclutch.com



www.indclutch.com

P-1867-C 3/18