

AMERIDRIVES (ZURN) EXPOSED BOLT (EB) GEAR COUPLINGS ASSEMBLY TOOL

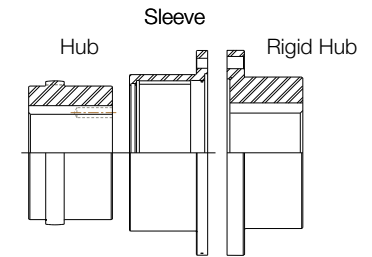
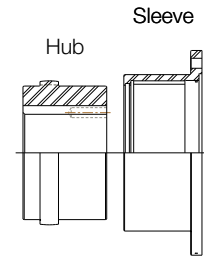
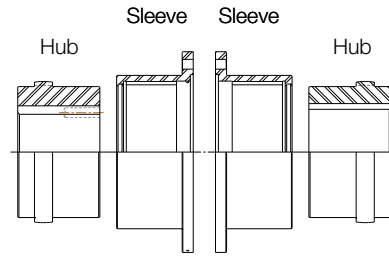
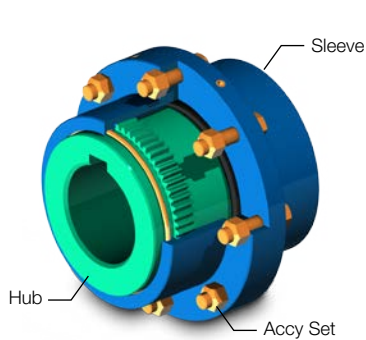

Complete Coupling		
2 Sleeve	2 Hub	1 Accy Set

Half Coupling		
1 Sleeve	1 Hub	1 Accy Set

Flex Rigid Coupling			
1 Sleeve	1 Hub	1 Accy Set	1 Rigid Hub

Size 201.25	Ameridrives Part Number	Size 201.5	Ameridrives Part Number	Size 202	Ameridrives Part Number	Size 202.5	Ameridrives Part Number
F201.25 C/F HUB RSB	040020-000	F201.5 C/F HUB RSB	073540-000	F202 C/F HUB RSB	073550-000	F202.5 C/F HUB RSB	073560-000
F201.25 SLEEVE A* (has counter-bored holes)	073907-003A	F201.5 EB SLEEVE	074254-001EB	F202 EB SLEEVE	074254-002EB	F202.5 EB SLEEVE	074254-003EB
F201.25 SLEEVE B* (has tapped holes)	073907-003B						
F201.25 ACCY SET	066268-003	F201.5 EB ACCY SET	074066-001	F202 EB ACCY SET	074066-002	F202.5 EB ACCY SET	074066-003
F201.25 EB RIGID HUB RSB (has tapped holes)	040023-002	F201.5 EB RIGID HUB RSB	040039-003	F202 EB RIGID HUB RSB	040059-003	F202.5 EB RIGID HUB RSB	040079-003

Size 203	Ameridrives Part Number	Size 203.5	Ameridrives Part Number	Size 204	Ameridrives Part Number	Size 204.5	Ameridrives Part Number
F203 C/F HUB RSB	073570-000	F203.5 C/F HUB RSB	073580-000	F204 C/F HUB RSB	073590-000	F204.5 C/F HUB RSB	073600-000
F203 EB SLEEVE	074254-004EB	F203.5 EB SLEEVE	074254-005EB	F204 EB SLEEVE	074254-006EB	F204.5 EB SLEEVE	074254-007EB
F203 EB ACCY SET	074066-004	F203.5 EB ACCY SET	074066-005	F204 EB ACCY SET	074066-006	F204.5 EB ACCY SET	074066-007
F203 EB RIGID HUB RSB	040099-003	F203.5 EB RIGID HUB RSB	040119-003	F204 EB RIGID HUB RSB	040139-003	F204.5 EB RIGID HUB RSB	040159-003

Size 205	Ameridrives Part Number	Size 205.5	Ameridrives Part Number	Size 206	Ameridrives Part Number	Size 207	Ameridrives Part Number
F205 C/F HUB RSB	073610-000	F205.5 C/F HUB RSB	073620-000	F206 C/F HUB RSB	073630-000	F207 C/F HUB RSB	073640-000
F205 EB SLEEVE	074254-008EB	F205.5 EB SLEEVE	074254-009EB	F206 EB SLEEVE	074254-010EB	F207 EB SLEEVE	074254-011EB
F205 EB ACCY SET	074066-008	F205.5 EB ACCY SET	074066-009	F206 EB ACCY SET	074066-010	F207 EB ACCY SET	074066-011
F205 EB RIGID HUB RSB	040179-003	F205.5 EB RIGID HUB RSB	040199-003	F206 EB RIGID HUB RSB	040219-003	F207 EB RIGID HUB RSB	040239-003

* F201.25 uses only (1) each of these sleeves

- All coupling hubs are RSB = Rough Stock Bore
- Also available - Consult Factory:

- Shrouded Bolt (SB) designs F201.5-F205.5
- Mill motor hubs

- Spacer Arrangements
- Floating Shaft Arrangements

Technical Questions or help building a Gear Coupling Part Number? Call Ameridrives Customer Service 1-512-353-4000

AMERIGEAR 200 SERIES O’RING GEAR COUPLING INTERCHANGE AND COMPARISON CHART

BRAND	SIZE	Flange Diameter	Bolt Pattern QTY @ EB Bolt	Bolt Pattern QTY @ SB Bolt	Max Bore	MAX Torque Rating (in-lbs)
Ameridrives	F201 1/2	6.00"	8 @ 4.81"	8 @ 4.81"	2.250	22,900
Falk	1015 G20				2.375	20,790
Kopflex	1 1/2H				2.250	17,000
Lovejoy	F1 1/2				2.125	18,900
Ameridrives	F202	7.00"	6 @ 5.88"	10 @ 5.88"	2.750	41,500
Falk	1020 G20				2.875	37,800
Kopflex	2H				2.750	31,500
Lovejoy	F2				2.750	31,500
Ameridrives	F202 1/2	8.38"	6 @ 7.12"	10 @ 7.00"	3.500	77,600
Falk	1025 G20				3.625	66,150
Kopflex	2 1/2H				3.500	56,700
Lovejoy	F2 1/2				3.250	56,700
Ameridrives	F203	9.44"	8 @ 8.12"	12 @ 8.00"	4.000	122,700
Falk	1030 G20				4.125	107,100
Kopflex	3H				4.000	101,000
Lovejoy	F3				4.000	94,500
Ameridrives	F203 1/2	11.00"	8 @ 9.50"	12 @ 9.25"	4.500	181,400
Falk	1035 G20				4.875	163,800
Kopflex	3 1/2H				4.500	148,000
Lovejoy	F3 1/2				4.625	151,200
Ameridrives	F204	12.50"	8 @ 11.00"	14 @ 10.62"	5.500	283,600
Falk	1040 G20				5.750	270,900
Kopflex	4H				5.500	236,000
Lovejoy	F4				5.375	220,500
Ameridrives	F204 1/2	13.62"	10 @ 12.00"	14 @ 11.75"	6.250	424,600
Falk	1045 G20				6.500	371,700
Kopflex	4 1/2H				6.000	318,000
Lovejoy	F4				6.000	302,400
Ameridrives	F205	15.31"	8 @ 13.50"	14 @ 13.19"	6.620	545,400
Falk	1050 G20				7.000	500,900
Kopflex	5H				6.875	441,000
Lovejoy	F5				6.500	434,700
Ameridrives	F205 1/2	16.75"	14 @ 14.50"	16 @ 14.44"	7.500	721,200
Falk	1055 G20				7.750	655,200
Kopflex	5 1/2H				7.750	580,000
Lovejoy	F5 1/2				7.375	573,300
Ameridrives	F206	18.00"	14 @ 15.75"	Not Available	8.250	934,200
Falk	1060 G20				8.750	800,100
Kopflex	6H				8.625	759,000
Lovejoy	F6				8.000	749,700
Ameridrives	F207	20.75"	16 @ 18.25"	Not Available	9.620	1,144,800
Falk	1070 G20				10.000	1,197,000
Kopflex	7H				10.375	1,160,000
Lovejoy	F7				9.000	1,008,400