

Comparison of Ameridrives Closed Eye to Split Eye Yokes

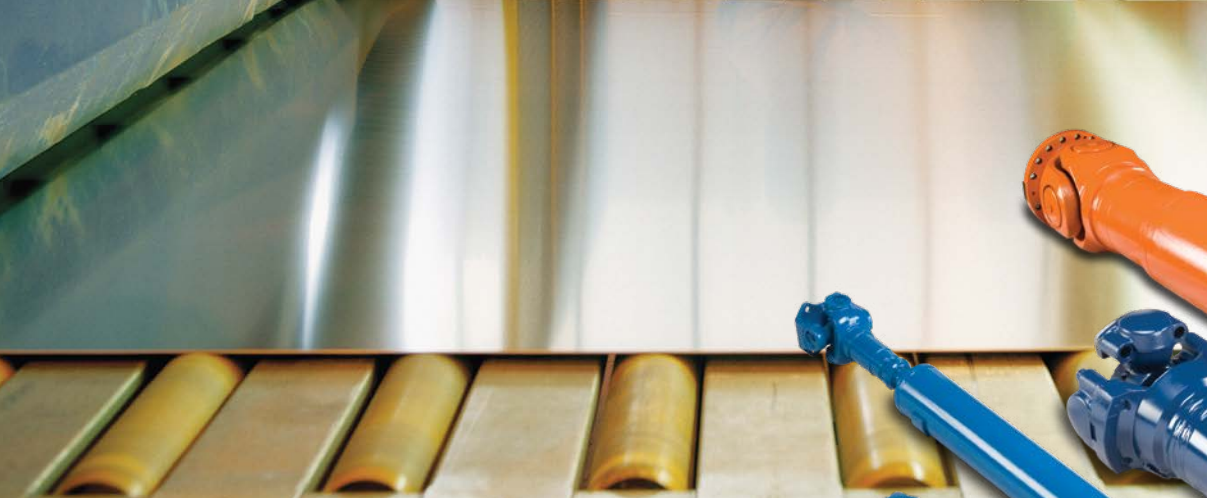



REDUCE MAINTENANCE COSTS AND AVOID COSTLY DOWNTIME DURING PRODUCTION WITH AMERIDRIVES CLOSED EYE YOKES

Ameridrives Universal Joints with Closed Eye Yokes

Americardan 2000 Series U Joints, Americardan 5000 and 3000 Series U-Joints, Americardan C Series Universal Joints, Americardan J Series Universal Joints

- One piece yoke and bearing housings.
- Ideal loading across entire bearing length due to balanced deflection between yoke and cross.
- No maintenance to verify if split eye bolts have loosened.
- Since there is no split there is no serration to wear.
- No extra bolted connections and serrations to maintain.
- All yoke components are interchangeable.
- No compromise of bearing diameter for retaining bolts for a given swing diameter.
- Greater bearing life under heavily loaded applications than split eye designs.
- Special tools are required for assembly and disassembly of joints, however except for lubrication, maintenance is generally not required for years due to superior bearing loading.
- Have successfully replaced split eye designs in problem applications.

Applications include:

- Steel Milling: Seamless Tube Piercing, Cold Strip, Slab Caster
- Drive Shafts On Marine Vessels
- Auto Shredders & Metals Recycling
- Fire Protection Pumping Systems

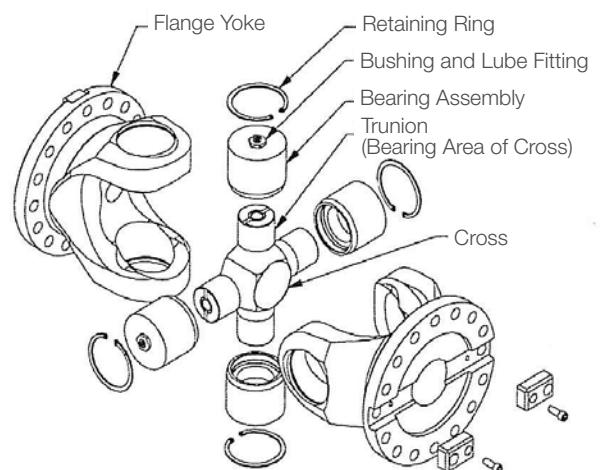



Split Eye Yokes

- Bearing bore is split into two sections and retained by a combination of serrations and bolts.
- Unequal bearing loads when peak torques spread split eye open.
- Under peak torques retainer bolts are stretched and lose initial prestretch, must continually verify for bolt loosening.
- Serration subject to wear.
- Bolted connections and serrations can corrode and prevent bearing bores from being restored.
- Main yoke body and split pieces must be matched for life to insure alignment of the bearing eye. This does not reduce spares requirement.
- Bearing diameter is reduced to allow for retaining bolts for a given swing diameter.
- Actual bearing life is significantly reduced in heavily loaded applications.
- Special tools are often required for assembly and disassembly of joints, frequent verification of retainer bolts at split eye for looseness is necessary. Looseness accelerates bearing wear. Corrosion can interfere with disassembly, i.e. bolt breakage, etc.
- Split eye manufacturers continue to offer one piece yoke designs for critical applications.

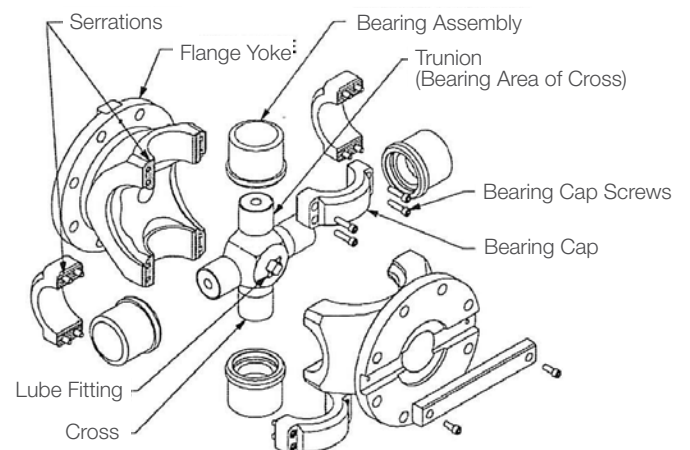

Ameridrives Facilities

North America

USA

1802 Pittsburgh Avenue
Erie, PA 16502 - USA
814-480-5000

*Mill Spindles, Ameriflex, Ameridisc,
Universal Joints, Driveshafts,
Mill Gear Couplings*

2000 Clovis Barker Road
San Marcos, TX 78666 - USA
888-449-9439

*Gear Couplings, Small Industrial
Driveshafts*

300 Indiana Highway 212
Michigan City, IN 46360
219-874-5248

Irrigation Universal Driveshafts

The Brands of Altra Motion

Couplings

Ameridrives
www.ameridrives.com

Bibby Turboflex
www.bibbyturboflex.com

Guardian Couplings
www.guardiancouplings.com

Huco
www.huco.com

Lamiflex Couplings
www.lamiflexcouplings.com

Stromag
www.stromag.com

TB Wood's
www.tbwoods.com

Linear Systems

Thomson
www.thomsonlinear.com

Warner Linear
www.warnerlinear.com

Geared Cam Limit Switches

Stromag
www.stromag.com

Engineered Bearing Assemblies

Kilian
www.kilianbearings.com

Electric Clutches & Brakes

Matrix
www.matrix-international.com

Stromag
www.stromag.com

Warner Electric
www.warnerelectric.com

Deltran
www.thomsonlinear.com

Belted Drives

TB Wood's
www.tbwoods.com

Heavy Duty Clutches & Brakes

Twiflex
www.twiflex.com

Stromag
www.stromag.com

Svendborg Brakes
www.svendborg-brakes.com

Wichita Clutch
www.wichitaclutch.com

Gearing & Specialty Components

Bauer Gear Motor
www.bauergears.com

Boston Gear
www.bostongear.com

Delevan
www.delevan.com

Delroyd Worm Gear
www.delroyd.com

Nuttall Gear
www.nuttallgear.com

Engine Braking Systems

Jacobs Vehicle Systems
www.jacobsvehiclesystems.com

Precision Motors & Automation

Kollmorgen
www.kollmorgen.com

Miniature Motors

Portescap
www.portescap.com

Overrunning Clutches

Formsprag Clutch
www.formsprag.com

Marland Clutch
www.marland.com

Stieber
www.stieberclutch.com

Neither the accuracy nor completeness of the information contained in this publication is guaranteed by the company and may be subject to change in its sole discretion. The operating and performance characteristics of these products may vary depending on the application, installation, operating conditions and environmental factors. The company's terms and conditions of sale can be viewed at <http://www.altramotion.com/terms-and-conditions/sales-terms-and-conditions>. These terms and conditions apply to any person who may buy, acquire or use a product referred to herein, including any person who buys from a licensed distributor of these branded products.

©2019 by Ameridrives LLC. All rights reserved. All trademarks in this publication are the sole and exclusive property of Ameridrives LLC or one of its affiliated companies.

