

# QUICK EXHAUST VALVES

125 PSIG  
1/8" to 3/4"



Instantaneous dumping of exhaust air permits use of smaller air valves and piping.  
Increases system efficiency and cycling speeds.

The Quick Exhaust Valves provide fast dumping of exhaust air at the cylinder, eliminating the need for large selector valves ordinarily required to accommodate exhaust air moving back through the pneumatic system. Initial savings and better operating efficiency result from the use of smaller air system components. In addition, smoother, faster cylinder operation and wider application of air-powered motions are obtained.

The Quick Exhaust Valve has been designed with smooth, over-size internal passages which afford unrestricted flow and prevent clogging due to contaminated air lines. The diaphragm is an exclusive design, which assures the instantaneous and complete venting of exhaust air from cylinders, air presses and other air-operated equipment.

## PRINCIPLE OF OPERATION

When air is introduced into the inlet port, the diaphragm is forced onto the exhaust seat. The outer lip of the diaphragm is deflected downward, away from the wall, allowing air to flow into the cylinder with a minimum of restriction. The diaphragm will remain on the exhaust seat as long as the inlet pressure is equal to or greater than the cylinder pressure.

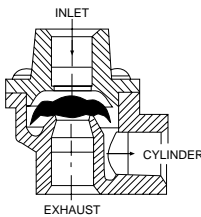

When the cylinder is fully charged and air is no longer flowing from inlet to cylinder port, the outer lip of the diaphragm will assume its normal shape and will contact the outer wall. The diaphragm will remain on the exhaust seat.

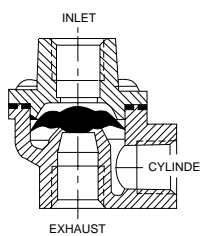

When pressure at the inlet port is vented to atmosphere (thru the control valve) the air in the cylinder, which is at a pressure level higher than atmosphere will force the diaphragm upwards to the inlet port. This will shut off the inlet port and allow air in the cylinder to flow directly to atmosphere.

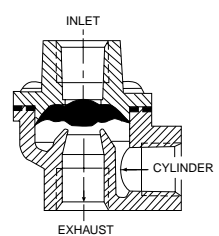

## ORDER BY CATALOG NUMBER OR ITEM CODE

| Catalog Number | Item Code | Inlet Port (NPT) | Inlet CV | Cylinder Port (NPT) | Exhaust Port (NPT) | Exhaust CV | Min ΔP To Shift Diaphragm (PSI) |
|----------------|-----------|------------------|----------|---------------------|--------------------|------------|---------------------------------|
| E341           | 70015     | 1/8              | 0.50     | 1/4                 | 1/4                | 1.00       | 5                               |
| E342           | 70016     | 1/4              | 1.21     | 1/4                 | 3/8                | 1.40       | 8                               |
| E343           | 70017     | 3/8              | 2.31     | 3/8                 | 3/8                | 2.86       | 8                               |
| E344           | 70018     | 1/2              | 3.48     | 1/2                 | 3/4                | 5.45       | 3                               |
| E345           | 70019     | 3/4              | 5.32     | 3/4                 | 3/4                | 7.84       | 3                               |

## DIMENSIONS

ΔP—Pressure differential

## SPECIFICATIONS

Body Material – Die Cast Aluminum  
Diaphragm – Nylon Reinforced  
Buna-N (Standard)  
– Viton (Optional)  
Operating Pressure Range –  
20-125 PSI  
Operating Temperature Range –  
Buna-N  
–40° to 212°F  
Viton –15° to 400°F

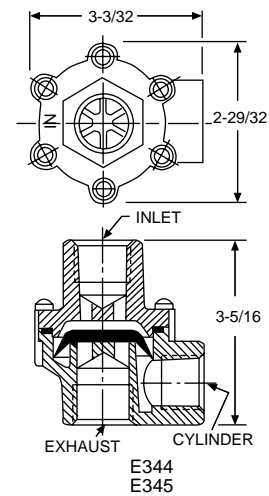
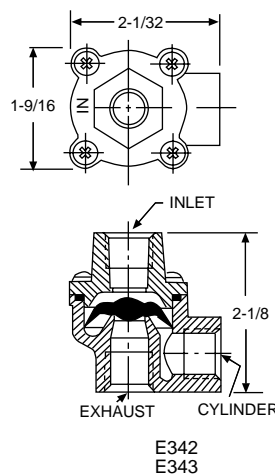
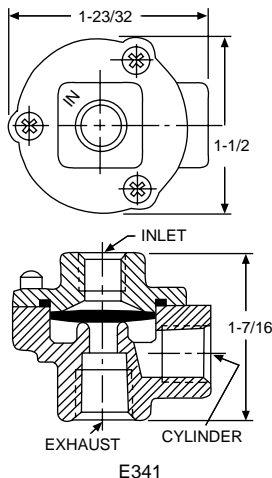

# FLOW CONTROL, NEEDLE, CHECK VALVES

2000 PSI (MAXIMUM)  
1/8" to 3/4" NPT

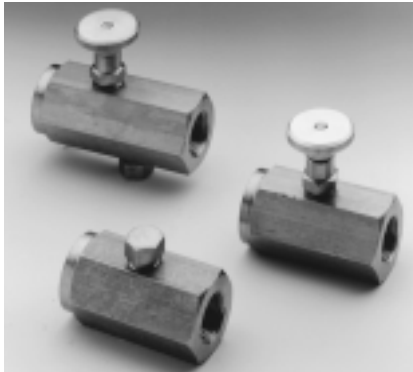

## SPECIFICATIONS

Max. Operating Pressure – 2000 PSI  
Operating Temperature Range – -15° to +400°F  
Standard Cracking Pressure – 1 to 2.5 PSI

### Materials:

Housing – Brass  
Needle – Brass  
Washer – Teflon  
Knob – Aluminum  
Ball – Stainless Steel  
Retainer – Stainless Steel  
O-Ring – Viton

## FLOW CONTROL VALVE with Free Reverse

A spring biased ball provides full flow in one direction; a tapered stainless steel needle provides a wide range of adjustment of flow in the controlled direction. A locknut prevents unwanted changes in adjustment. An aluminum knurled knob is standard.

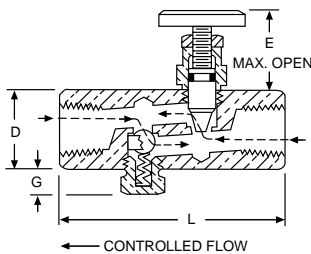

## NEEDLE VALVE

A wide range of flow adjustment is possible because of the fine threaded tapered needle. Unwanted changes in adjustment are prevented by a locknut. An aluminum knurled knob is standard.

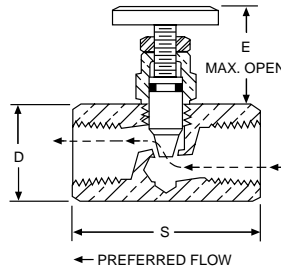

## CHECK VALVE

A slight pressure differential fully opens or closes the check valve. This valve is supplied standard with a ball check.

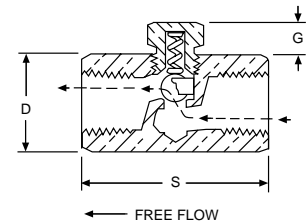

### ALL DIMENSIONS IN INCHES

| Size (NPTF) | D Hex  | E      | G     | L      | S       |
|-------------|--------|--------|-------|--------|---------|
| 1/8         | 11/16  | 7/8    | 13/64 | 1-3/4  | 1-15/32 |
| 1/4         | 7/8    | 1      | 23/64 | 2-3/8  | 2       |
| 3/8         | 1-1/16 | 1-3/16 | 11/32 | 2-3/4  | 2-1/4   |
| 1/2         | 1-5/16 | 1-7/16 | 15/32 | 3-3/16 | 2-21/32 |
| 3/4         | 1-5/8  | 1-5/8  | 17/32 | 3-9/16 | 2-15/16 |

### ORDER BY CATALOG NUMBER OR ITEM CODE

| Size (NPTF) | FLOW CONTROL VALVE |           |      |            | NEEDLE VALVE   |           |      |            | CHECK VALVE    |           |      |            |
|-------------|--------------------|-----------|------|------------|----------------|-----------|------|------------|----------------|-----------|------|------------|
|             | Catalog Number     | Item Code | CV   | Flow (GPM) | Catalog Number | Item Code | CV   | Flow (GPM) | Catalog Number | Item Code | CV   | Flow (GPM) |
| 1/8         | E311               | 70000     | .23  | 1.5        | E321           | 70005     | .20  | 3.2        | E331           | 70010     | .23  | 1.5        |
| 1/4         | E312               | 70001     | .54  | 3.0        | E322           | 70006     | .43  | 7.0        | E332           | 70011     | .54  | 3.0        |
| 3/8         | E313               | 70002     | .83  | 5.0        | E323           | 70007     | .78  | 13.5       | E333           | 70012     | .83  | 5.0        |
| 1/2         | E314               | 70003     | 1.47 | 8.0        | E324           | 70008     | 1.24 | 22.5       | E334           | 70013     | 1.47 | 8.0        |
| 3/4         | E315               | 70004     | 1.90 | 12.0       | E325           | 70009     | 1.93 | 34.0       | E335           | 70014     | 1.90 | 12.0       |

**BOSTON GEAR®**

# INLINE CHECK and SHUT-OFF VALVES

## INLINE CHECK VALVE 2000 PSI MAXIMUM 1/4" to 3/4" NPTF



Inline check valves fully open or close with the application of a slight differential pressure. The ball check provides full flow in one direction, yet assures a positive leak-tight seal for liquids in the other direction. A stainless steel ball check is standard.

### SPECIFICATIONS

Body – Brass  
Spring – Steel  
Ball – Stainless Steel  
Standard cracking pressure 1 to 2.5 psi

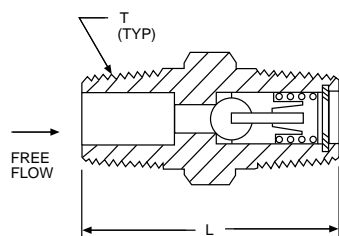

ORDER BY CATALOG NUMBER OR ITEM CODE  
ALL DIMENSIONS IN INCHES

| Pipe Size (NPTF) | Catalog Number | Item Code | Cv   | Flow GPM | Hex   | L      | Maximum Operating Pressure PSI |
|------------------|----------------|-----------|------|----------|-------|--------|--------------------------------|
| 1/4              | J3320          | 70020     | .56  | 2.5      | 5/8   | 1-3/8  | 2000                           |
| 3/8              | J3330          | 70021     | 1.31 | 6.0      | 3/4   | 1-5/8  | 2000                           |
| 1/2              | J3340          | 70022     | 2.71 | 10.0     | 7/8   | 2-1/16 | 1000                           |
| 3/4              | J3350          | 70023     | 3.40 | 15.0     | 1-1/8 | 2-1/4  | 1000                           |

## SHUT OFF VALVE 10,000 PSI MAXIMUM 1/4" to 1/2" NPTF



These Shut-Off Valves are ideal for use in applications requiring excellent flow characteristics as well as positive shut-off service, such as natural gas lines, chemical processing and machine tool service lines. The shut-off stem has 20 threads per inch for fast shut off. Globe type valves can be furnished for panel mounting by the use of a panel mounting nut and a washer. These valves open and close easily under pressure.

### SPECIFICATIONS

Max. Operating Pressure – 10,000 PSI  
Non Shock Service  
Min. Burst Pressure – 20,000 PSI  
Operating Temperature Range – -40°F to +212°F  
Body Material – Carbon Steel  
Stem – 416 Stainless Steel  
Packing – Buna-N  
Stem Gland – Brass  
Handle – Die Casting

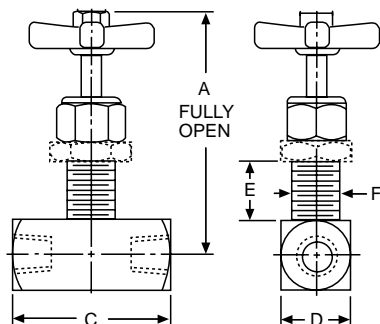

ORDER BY CATALOG NUMBER OR ITEM CODE  
ALL DIMENSIONS IN INCHES

| Size (NPTF) | Catalog Number | Item Code | CV*  | A       | C     | D     | E    | F        |
|-------------|----------------|-----------|------|---------|-------|-------|------|----------|
| 1/4         | J2250-2        | 70032     | .47  | 3-1/16  | 2     | 7/8   | 3/16 | 3/4-20   |
| 3/8         | J2250-3        | 70033     | 1.00 | 4-1/32  | 2-3/8 | 1     | 1/4  | 15/16-20 |
| 1/2         | J2250-4        | 70034     | 1.10 | 3-15/16 | 2-7/8 | 1-1/4 | 1/4  | 15/16-20 |

\*Fully Open

# SHUTTLE and SLIDE VALVES

## SHUTTLE VALVES 1/8" & 1/4" NPTF

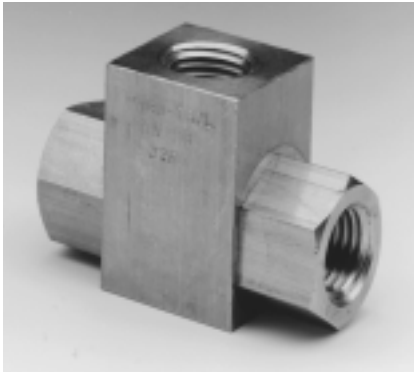

The shuttle valve operates as a three way valve with two inlet ports and one outlet port. The check ball moves away from the inlet port with the greatest differential pressure and against the port having the least differential pressure.

### SPECIFICATIONS

Maximum Operating Pressure (Non Shock): 200 PSI  
 Material: Body: Brass  
 Check Ball: Buna-N  
 Temperature Range: -40° to +212°F

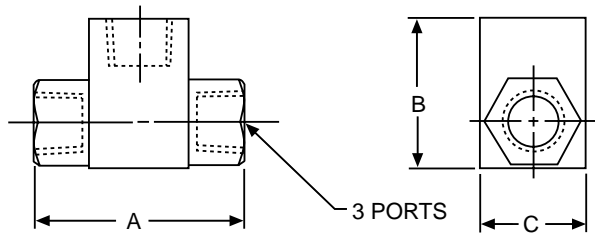

ALL DIMENSIONS IN INCHES  
 ORDER BY CATALOG NUMBER OR ITEM CODE

| Size (NPTF) | Catalog Number | Item Code | A     | B       | C   | C <sub>v</sub> |
|-------------|----------------|-----------|-------|---------|-----|----------------|
| 1/8         | E351           | 74390     | 1-1/4 | 31/32   | 5/8 | .74            |
| 1/4         | E352           | 74391     | 1-7/8 | 1-15/16 | 7/8 | 1.35           |

## SLIDE VALVES 1/8" to 1/2" NPTF



The slide valve is a manually operated, two position, three way valve for pneumatic applications. It permits instant gauge reading, with the gauge vented to atmosphere when the valve sleeve slides into the other position. Also ideal for applications such as air clamps and single acting cylinders.

Maximum Operating Pressure (Non Shock): 250 PSI  
 Material: Body – Steel (Black Oxide)  
 Sleeve – Brass  
 Retaining Ring – Steel  
 O-Ring – Buna-N  
 Temperature Range: -40° to +212°F

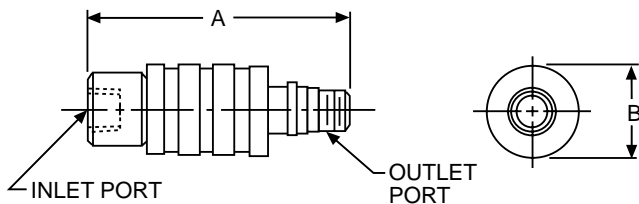

ALL DIMENSIONS IN INCHES  
 ORDER BY CATALOG NUMBER OR ITEM CODE

| Size (NPTF) | Catalog Number | Item Code | A       | B (Dia.) | C <sub>v</sub> |
|-------------|----------------|-----------|---------|----------|----------------|
| 1/8         | E381           | 74395     | 2-1/2   | 7/8      | .98            |
| 1/4         | E382           | 74396     | 2-3/4   | 1-1/8    | 1.53           |
| 3/8         | E383           | 74397     | 2-13/16 | 1-1/8    | 1.78           |
| 1/2         | E384           | 74398     | 3-3/4   | 1-1/2    | 3.26           |

# MUFFLERS and BREATHER VENTS

## MUFFLER-FILTER 1/8" to 1-1/2" NPTF



### SPECIFICATIONS

Maximum Pressure: 300 PSI  
Temperature Range: 40° to 300°F

Exhaust mufflers utilize porous sintered bronze (40 micron) directly bonded to copper plated steel thread pipe fittings to diffuse air and muffle noise from the exhaust ports of valves, cylinders and air tools.

These units offer a combination of small size with the greatest possible sound deadening qualities to reduce exhaust noise to acceptable levels within OSHA's noise requirements.

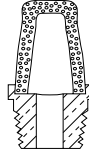

ALL DIMENSIONS IN INCHES  
ORDER BY CATALOG NUMBER OR ITEM CODE

| Size (NPTF) | Catalog Number | Item Code | Length  | Hex     |
|-------------|----------------|-----------|---------|---------|
| 1/8         | E621           | 70371     | 1-1/8   | 7/16    |
| 1/4         | E622           | 70372     | 1-3/8   | 9/16    |
| 3/8         | E623           | 70373     | 1-1/2   | 9/16    |
| 1/2         | E624           | 70374     | 1-7/8   | 7/8     |
| 3/4         | E625           | 70375     | 2-1/4   | 1-1/16  |
| 1           | E626           | 70376     | 2-7/8   | 1-5/16  |
| 1-1/4       | E627           | 70377     | 3-1/4   | 1-11/16 |
| 1-1/2       | E628           | 70378     | 3-11/16 | 2       |

### SPECIFICATIONS

Maximum Pressure: 300 PSI  
Temperature Range: 40° to 300°F

Speed control muffler units provide an infinite variation of metering airflow at an acceptable sound level on exhaust ports of air valves with complete safety. The speed of an operating cylinder or air tool may be increased or decreased with an adjusting screw which can then be locked in place by a locknut. Objectionable exhaust air noise is eliminated by the surrounding sleeve of 40 micron sintered bronzes.

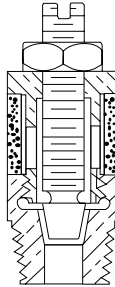

## SPEED CONTROL MUFFLER 1/8" to 1" NPTF

ALL DIMENSIONS IN INCHES  
ORDER BY CATALOG NUMBER OR ITEM CODE

| Size (NPTF) | Catalog Number | Item Code | Length Open | Hex    | Max Flow (SCFM) |
|-------------|----------------|-----------|-------------|--------|-----------------|
| 1/8         | E631           | 70418     | 1-5/16      | 1/2    | 20              |
| 1/4         | E632           | 70419     | 1-9/16      | 9/16   | 30              |
| 3/8         | E633           | 70420     | 1-5/8       | 11/16  | 40              |
| 1/2         | E634           | 70421     | 2           | 7/8    | 60              |
| 3/4         | E635           | 70422     | 2-3/8       | 1-1/16 | 70              |
| 1           | E636           | 70423     | 2-3/8       | 1-5/16 | 100             |

### SPECIFICATIONS

Maximum Pressure: 300 PSI  
Temperature Range: 40° to 160°F

Coalescing mufflers are installed in the exhaust ports of pneumatic valves, motors and other air operated devices to reduce work area noise and oil mist from the exhaust air. In addition, they prevent contaminants from entering open exhaust ports and causing premature valve failure. Replaceable fiberglass elements are available.

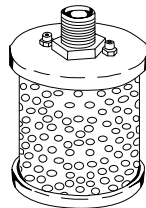

## COALESCING MUFFLERS 1/2" to 1" NPTF

ALL DIMENSIONS IN INCHES  
ORDER BY CATALOG NUMBER OR ITEM CODE

| Size (NPTF)         | Catalog Number | Item Code | C <sub>v</sub> | Diameter | Length |
|---------------------|----------------|-----------|----------------|----------|--------|
| 1/2                 | EFMC-4         | 87419     | 5.2            | 3-7/8    | 6      |
| 3/4                 | EFMC-6         | 87090     | 9.2            | 3-7/8    | 6      |
| 1                   | EFMC-8         | 70604     | 15.7           | 3-7/8    | 6-3/16 |
| Replacement Element | RCMC-468       | 87017     |                |          |        |

### SPECIFICATIONS

Maximum Pressure: 150 PSI  
Temperature Range: 40° to 300°F

Breather vents have many applications including single acting cylinders to prevent dirt and foreign particles from entering ports opened to the atmosphere. 1/8" to 3/4" units are constructed of 40 micron sintered bronze and brass, Larger sizes use a plated steel insert.

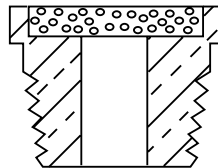

## BREATHER VENT 1/8" to 1-1/2" NPTF

ALL DIMENSIONS IN INCHES  
ORDER BY CATALOG NUMBER OR ITEM CODE

| Size (NPTF) | Catalog Number | Item Code | Length  | Hex     |
|-------------|----------------|-----------|---------|---------|
| 1/8         | E641           | 70424     | 7/16    | 7/16    |
| 1/4         | E642           | 70425     | 5/8     | 9/16    |
| 3/8         | E643           | 70426     | 3/4     | 11/16   |
| 1/2         | E644           | 70427     | 7/8     | 7/8     |
| 3/4         | E645           | 70428     | 1       | 1-1/16  |
| 1           | E646           | 70429     | 1-5/16  | 1-5/16  |
| 1-1/4       | E647           | 70430     | 1-13/32 | 1-11/16 |
| 1-1/2       | E648           | 70431     | 1-1/2   | 2       |

# MUFFLERS and BREATHER VENTS

## EXHAUST SILENCERS 1/8" to 2" NPT



**MODEL EBB  
(Male Threads)**

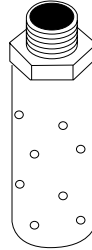

### SPECIFICATIONS

Maximum Pressure: 300 PSI  
Maximum Temperature: 160°F

### MATERIALS:

Elements: Brass wire  
Base: Aluminum  
Shell: Aluminum

Exhaust Silencers installed in the exhaust ports of pneumatic valves can be a quick and inexpensive method to help reduce work area noise.

ALL DIMENSIONS IN INCHES  
ORDER BY CATALOG NUMBER OR ITEM CODE

| Pipe Size (NPT) | Catalog Number | Item Code | CV   | Hex   | Length  |
|-----------------|----------------|-----------|------|-------|---------|
| 1/8             | EBB-1          | 74516     | 1.3  | 13/16 | 2       |
| 1/4             | EBB-2          | 74517     | 2.3  | 13/16 | 2-3/16  |
| 3/8             | EBB-3          | 74519     | 2.9  | 1-1/4 | 3-15/32 |
| 1/2             | EBB-4          | 74527     | 6.8  | 1-1/4 | 3-5/8   |
| 3/4             | EBB-6          | 74528     | 7.2  | 2     | 5-3/16  |
| 1               | EBB-8          | 74529     | 18.0 | 2     | 5-5/16  |

ALL DIMENSIONS IN INCHES  
ORDER BY CATALOG NUMBER OR ITEM CODE

| Pipe Size (NPT) | Catalog Number | Item Code | CV   | Hex   | Length  |
|-----------------|----------------|-----------|------|-------|---------|
| 1/8             | EAA-1          | 74504     | 0.8  | 13/16 | 1-11/16 |
| 1/4             | EAA-2          | 74505     | 2.4  | 13/16 | 1-13/16 |
| 3/8             | EAA-3          | 74506     | 5.7  | 1-1/4 | 3-1/8   |
| 1/2             | EAA-4          | 74507     | 6.9  | 1-1/4 | 3-5/16  |
| 3/4             | EAA-6          | 74508     | 18.0 | 2     | 4-1/2   |
| 1               | EAA-8          | 74511     | 20.0 | 2     | 4-1/2   |
| 1-1/4           | EAA-10         | 74512     | 42.0 | 2-1/2 | 5-9/16  |
| 1-1/2           | EAA-12         | 74514     | 39.0 | 2-1/2 | 5-9/16  |
| 2               | EAA-16         | 74515     | 59.0 | 3     | 6-7/16  |

**MODEL EAA  
(Female Threads)**

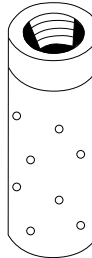

## INLINE FILTER 1/8" and 1/4" NPT



### SPECIFICATIONS

Maximum Pressure: 500 PSI  
Temperature Range: 40° to 400°F

This pneumatic "In-Line Filter" is designed specifically for the protection of small air tools such as impact wrenches, nut runners, grinders, screw drivers and other pneumatic tools. This filter will reduce down-time and prevent costly repairs of tools in addition to extending their life.

Filter may be used for fluids such as oil, and air. Elements may be obtained in 20 and 90 micron filtrations on special order. The standard element is 40 micron filtration, which gives minimum pressure drop. All anodized aluminum housing is compact and light weight which allows it to be used directly before the air tool.

ALL DIMENSIONS IN INCHES  
ORDER BY CATALOG NUMBER OR ITEM CODE

| NPT Size | Catalog Number | Item Code | Overall Length | Hex |
|----------|----------------|-----------|----------------|-----|
| 1/8      | E41-9071       | 70782     | 2-3/16         | 3/4 |
| 1/4      | E41-9072       | 70783     | 2-5/16         | 3/4 |

ORDER BY CATALOG NUMBER OR ITEM CODE

| Replacement Elements               | Catalog Number | Item Code |
|------------------------------------|----------------|-----------|
| 1/8 & 1/4 Filter Element 40 Micron | E41-9071-6     | 70784     |
| 1/8 & 1/4 Filter Element 20 Micron | E41-9071-6-20  | 70785     |
| 1/8 & 1/4 Filter Element 90 Micron | E41-9071-6-90  | 70786     |

# NYLON TUBING and RECOILING HOSE

## RECOILING HOSE ASSEMBLIES

1/4" to 3/8" DIA.



Ideally suited to supply air to Blow Guns, pneumatically powered drills, screwdrivers, sanders, grinders or other hand held devices, this lightweight, self-retracting nylon hose automatically recoils to a fraction of its full length to keep work areas clear of bulky air lines.

Maximum working pressure is 180 psi, at room temperatures. Spring guards are provided to protect hose from kinking and associated flow restriction and hose damage.

360° swivel fittings are provided to protect hose from unnecessary twisting.

ALL DIMENSIONS IN INCHES EXCEPT AS NOTED  
ORDER BY CATALOG NUMBER OR ITEM CODE

| Hose I.D. | Catalog Number | Item Code | Length (Feet) | Nominal Compact Fittings (NPT) | Recommended Length | Nominal Outside Max. Work (Feet) | Coil Dia. |
|-----------|----------------|-----------|---------------|--------------------------------|--------------------|----------------------------------|-----------|
| 1/4       | E50204-12      | 70787     | 12            | 1/4                            | 6                  | 10                               | 3         |
|           | E50204-25      | 70788     | 25            | MALE                           | 12                 | 22                               |           |
|           | E50204-50      | 70789     | 50            |                                | 23                 | 45                               |           |
| 3/8       | E50206-25      | 70790     | 25            | 3/8                            | 10                 | 21                               | 5-1/2     |
|           | E50206-50      | 70791     | 50            | MALE                           | 20                 | 42                               |           |

## REPLACEMENT FITTINGS RECOILING HOSE

### 360° SWIVEL FITTING

Includes: Female, Insert, Guard Spring, Nut & Swivel Body.

ORDER BY CATALOG NUMBER OR ITEM CODE

| Hose I.D. (Inches) | Catalog Number | Item Code | Fittings NPT |
|--------------------|----------------|-----------|--------------|
| 1/4                | E50204-99      | 70792     | 1/4          |
| 3/8                | E50206-99      | 70793     | 3/8          |

## NYLON TUBING 100 FOOT PACKAGES 1/8" to 1/2" DIA.

### APPLICATIONS INCLUDE:

Air Logic Systems  
Air, Chemical Handling and Lubricant Lines  
Low Pressure Hydraulics

FLEXIBLE AND LIGHTWEIGHT  
EXCELLENT DIMENSIONAL STABILITY  
RESISTANT TO WIDE RANGE OF CHEMICALS  
WITHSTANDS ABRASION  
LOW MOISTURE ABSORPTION  
TEMPERATURE RANGE – 60°F to 180°F  
BURST PRESSURE (AT 75°F) 1000 PSI  
O.D. TOLERANCE      1/8 : –.005 +.003  
   BAL : –.006 +.003

ALL DIMENSIONS IN INCHES  
ORDER BY CATALOG NUMBER OR ITEM CODE

| Outside Diameter | Catalog Number | Item Code | Wall Thickness | Color   | Minimum Bend Radius |
|------------------|----------------|-----------|----------------|---------|---------------------|
| 1/8              | E52202         | 70497     | .016           | Natural | 1/2                 |
| 3/16             | E52203         | 70498     | .025           | Natural | 3/4                 |
| 3/16             | E52303         | 70499     | .025           | Black   | 3/4                 |
| 1/4              | E52204         | 70500     | .035           | Natural | 7/8                 |
| 1/4              | E52304         | 70501     | .035           | Black   | 7/8                 |
| 3/8              | E52206         | 70504     | .050           | Natural | 1-1/4               |
| 3/8              | E52306         | 70505     | .050           | Black   | 1-1/4               |
| 1/2              | E52208         | 70506     | .062           | Natural | 2-1/4               |
| 1/2              | E52308         | 70507     | .062           | Black   | 2-1/4               |

# TUBE FITTINGS

**PUSH-IN TYPE**  
1/8" to 1/2" TUBE OD

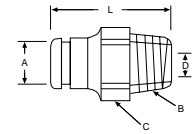
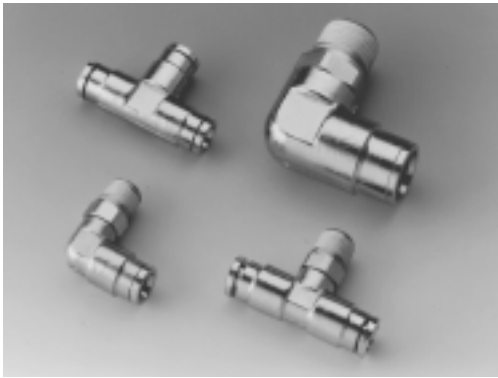

## STRAIGHT MALE ADAPTER

ORDER BY CATALOG NUMBER OR ITEM CODE

| A<br>Tube<br>O.D. | B<br>Thread<br>NPT | Catalog<br>Number | Item<br>Code | C<br>Across<br>Flats | D<br>Internal<br>Hex | L<br>Dim. |
|-------------------|--------------------|-------------------|--------------|----------------------|----------------------|-----------|
| 1/8               | 10-32*             | EN51908-0200      | 75544        | .315**               | 3/32                 | 0.79      |
| 1/8               | 1/8                | EN51908-0202      | 75545        | 7/16                 | 3/32                 | 0.67      |
| 1/4               | 1/8                | EN51908-0402      | 75546        | 7/16                 | 5/32                 | 0.98      |
| 1/4               | 1/4                | EN51908-0404      | 75547        | 9/16                 | 5/32                 | 1.11      |
| 3/8               | 1/4                | EN51908-0604      | 75548        | 11/16                | 9/32                 | 1.47      |
| 3/8               | 3/8                | EN51908-0606      | 75549        | 11/16                | 5/16                 | 1.41      |
| 1/2               | 3/8                | EN51908-0806      | 75550        | 7/8                  | 13/32                | 1.63      |
| 1/2               | 1/2                | EN51908-0808      | 75551        | 7/8                  | 13/32                | 1.70      |

\*UNF

\*\*DIA

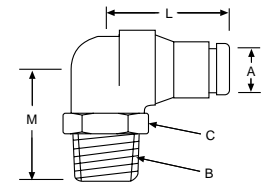

## 90° ELBOW, SWIVEL ADAPTER

ORDER BY CATALOG NUMBER OR ITEM CODE

| A<br>Tube<br>O.D. | B<br>Thread<br>NPT | Catalog<br>Number | Item<br>Code | C<br>Across<br>Flats | L<br>Dim. | M<br>Dim |
|-------------------|--------------------|-------------------|--------------|----------------------|-----------|----------|
| 1/8               | 10-32*             | EN51911-0200      | 75552        | 5/16                 | 0.63      | 0.73     |
| 1/8               | 1/8                | EN51911-0202      | 75554        | 7/16                 | 0.63      | 0.82     |
| 1/4               | 1/8                | EN51911-0402      | 75555        | 7/16                 | 0.77      | 0.90     |
| 1/4               | 1/4                | EN51911-0404      | 75556        | 9/16                 | 0.77      | 1.11     |
| 3/8               | 1/4                | EN51911-0604      | 75557        | 11/16                | 1.05      | 1.26     |
| 3/8               | 3/8                | EN51911-0606      | 75558        | 3/4                  | 1.05      | 1.26     |
| 1/2               | 3/8                | EN51911-0806      | 75559        | 3/4                  | 1.25      | 1.41     |
| 1/2               | 1/2                | EN51911-0808      | 75560        | 7/8                  | 1.25      | 1.62     |

\*UNF

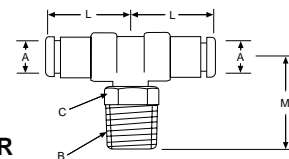

## BRANCH TEE SWIVEL ADAPTER

ORDER BY CATALOG NUMBER OR ITEM CODE

| A<br>Tube<br>O.D. | B<br>Thread<br>NPT | Catalog<br>Number | Item<br>Code | C<br>Across<br>Flats | L<br>Dim. | M<br>Dim |
|-------------------|--------------------|-------------------|--------------|----------------------|-----------|----------|
| 1/8               | 10-32*             | EN51912-0200      | 75561        | 5/16                 | 0.63      | 0.73     |
| 1/8               | 1/8                | EN51912-0202      | 75568        | 7/16                 | 0.63      | 0.81     |
| 1/4               | 1/8                | EN51912-0402      | 75659        | 7/16                 | 0.77      | 0.90     |
| 1/4               | 1/4                | EN51912-0404      | 75662        | 9/16                 | 0.77      | 1.11     |
| 3/8               | 1/4                | EN51912-0604      | 75663        | 11/16                | 1.05      | 1.26     |
| 3/8               | 3/8                | EN51912-0606      | 75664        | 3/4                  | 1.05      | 1.26     |
| 1/2               | 3/8                | EN51912-0806      | 75665        | 3/4                  | 1.25      | 1.41     |
| 1/2               | 1/2                | EN51912-0808      | 75666        | 7/8                  | 1.25      | 1.62     |

\*UNF

Designed for use with Nylon (see page 120) or Hytrel flexible tubing. This push-in series of fittings provides easy tube insertion, positive retention and a simple means of connecting compressed air products to system piping.

- Rated up to 270 PSIG
- Bright nickel plated
- Non-PTFE bases thread sealant
- Silicon free O-rings
- Internal hexagon

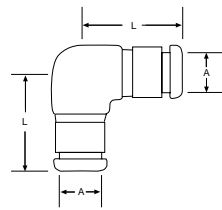

## ELBOW CONNECTOR (TUBE)

ORDER BY CATALOG NUMBER  
OR ITEM CODE

| A<br>Tube<br>O.D. | Catalog<br>Number | Item<br>Code | L<br>Dim. |
|-------------------|-------------------|--------------|-----------|
| 1/8               | EN51906-0202      | 75516        | 0.65      |
| 1/4               | EN51906-0404      | 75537        | 0.77      |
| 3/8               | EN51906-0606      | 75538        | 1.05      |

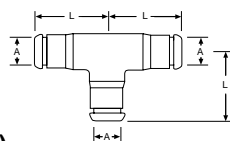

## TEE CONNECTOR (TUBE)

ORDER BY CATALOG NUMBER  
OR ITEM CODE

| A<br>Tube<br>O.D. | Catalog<br>Number | Item<br>Code | L<br>Dim. |
|-------------------|-------------------|--------------|-----------|
| 1/8               | EN51907-0202      | 75540        | 0.63      |
| 1/4               | EN51907-0404      | 75541        | 0.77      |
| 3/8               | EN51907-0606      | 75542        | 1.05      |



# BLOW GUNS

## BLOW GUNS 1/4" NPT



### FEATURES:

- FLOW STABILIZER VALVE for precise air control
- CONTOURED DESIGN to comfortably fit operator's hand
- CHROME PLATED, LIGHTWEIGHT ZINC BODY
- CUSHIONED THUMB LEVER
- LARGE HANGING HOOK
- MEETS OSHA REQUIREMENTS of 30 PSI maximum outlet pressure when dead-ended up to 150 PSI inlet pressure

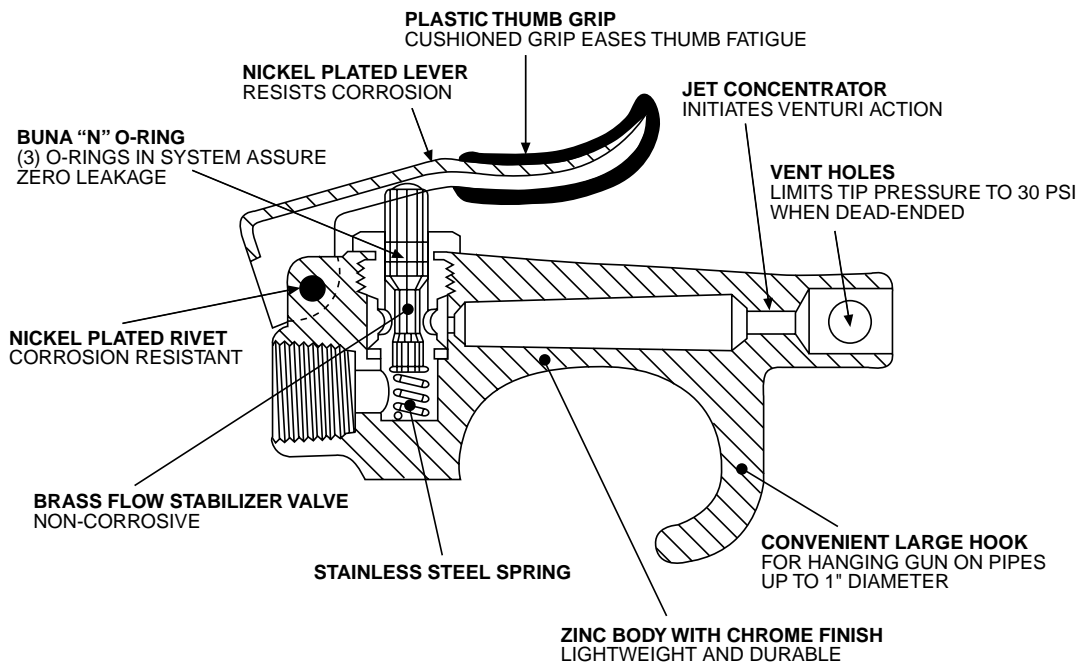

ORDER BY CATALOG NUMBER  
OR ITEM NUMBER

| Port NPT             | Catalog Number | Item Code |
|----------------------|----------------|-----------|
| <b>Standard</b>      |                |           |
| 1/4                  | BE65A          | 71667     |
| <b>Super Booster</b> |                |           |
| 1/4                  | BE65SB         | 76827     |

### STANDARD MODEL

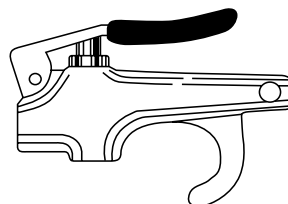

### SUPER BOOSTER MODEL

High Flow at Lower Velocity

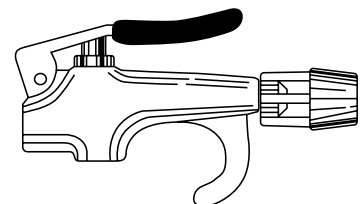

# QUICK DISCONNECT COUPLING

## SINGLE SHUT-OFF



Quick disconnect coupling with a shut-off valve in one half.

For applications where automatic connecting action is not required.

Rugged coupling has a simple connecting action. Pull back the sleeve, insert the plug and release sleeve.

Boston Gear's standard utility series offers all the basic features necessary for a long wearing single shut-off coupling. Ideal for any industrial type pneumatic application where quick connections and disconnections are required. Our design provides uniform 360° valve-to-lug contact for maximum air flow and extended coupling life.

Rugged steel construction features multi-ball-bearing plug latching and complete zinc chromate plating for resistance to moisture caused corrosion.

### SPECIFICATIONS:

CONSTRUCTION—All steel with zinc chromate finish inside and out

SEALS— Buna-N

PRACTICAL WORKING PRESSURE— 500 PSI

BURST PRESSURE — 5000 PSI

SIZES— 1/4" and 1/2" (connection size 1/8" through 1/2")

INTERCHANGEABILITY—All couplings meet the dimensional requirements of Mil-C-4109, and are interchangeable with other couplings of the same size that meet the same military specification

## SOCKETS

ORDER BY CATALOG NUMBER  
OR ITEM CODE

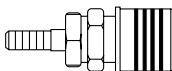
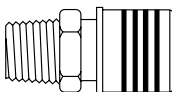
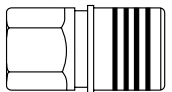

| Pipe Size (NPT)           | Flow (SCFM) | Catalog Number | Item Code |
|---------------------------|-------------|----------------|-----------|
| <b>FEMALE PIPE THREAD</b> |             |                |           |
| 1/8                       | 46          | E57111-02      | 71946     |
| 1/4                       | 46          | E57111-04      | 70456     |
| 3/8                       | 46          | E57111-06      | 71940     |
| 1/2                       | 160         | E57121-08      | 70462     |
| <b>MALE PIPE THREAD</b>   |             |                |           |
| 1/8                       | 46          | E57112-02      | 71947     |
| 1/4                       | 46          | E57112-04      | 70457     |
| 3/8                       | 46          | E57112-06      | 71941     |
| 1/2                       | 160         | E57122-08      | 70463     |
| <b>HOSE STEM</b>          |             |                |           |
| 1/4                       | 46          | E57113-04      | 70458     |
| 3/8                       | 46          | E57113-06      | 71942     |
| 1/2                       | 160         | E57123-08      | 70464     |

## PLUGS

ORDER BY CATALOG NUMBER  
OR ITEM CODE

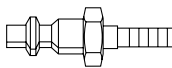
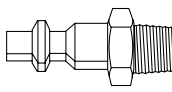
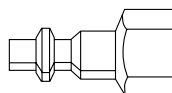

| Pipe Size (NPT)           | Flow (SCFM) | Catalog Number | Item Code |
|---------------------------|-------------|----------------|-----------|
| <b>FEMALE PIPE THREAD</b> |             |                |           |
| 1/8                       | 46          | E57211-02      | 71949     |
| 1/4                       | 46          | E57211-04      | 70459     |
| 3/8                       | 46          | E57211-06      | 71943     |
| 1/2                       | 160         | E57221-08      | 70465     |
| <b>MALE PIPE THREAD</b>   |             |                |           |
| 1/8                       | 46          | E57212-02      | 71948     |
| 1/4                       | 46          | E57212-04      | 70460     |
| 3/8                       | 46          | E57212-06      | 71944     |
| 1/2                       | 160         | E57222-08      | 70466     |
| <b>HOSE STEM</b>          |             |                |           |
| 1/4                       | 46          | E57213-04      | 70461     |
| 3/8                       | 46          | E57213-06      | 71945     |
| 1/2                       | 160         | E57223-08      | 70467     |

**BOSTON GEAR®**

# SAFETY WARNINGS

---

## *AIR PREPARATION PRODUCTS*

These Filter/Regulator/Lubricators are intended for use in industrial compressed air systems only. They must not be used where the pressure or temperature may exceed the maximum rated operating conditions. Before using with fluids other than air, for non-industrial applications, or for life support systems consult Boston Gear.

The polycarbonate plastic bowls used on some of these Filter/Regulator/Lubricators can be damaged and possibly burst if exposed to such substances as certain solvents, strong alkalies, compressor oils containing ester-based additives or synthetic oils. Fumes of these substances in contact with the polycarbonate bowl, externally or internally, can also result in damage. Clean with warm water only. Use a metal bowl in applications where a plastic bowl might be exposed to substances that are incompatible with the polycarbonate.

If the outlet pressures in excess of the Filter/Regulator/Lubricators pressure setting could cause downstream equipment to rupture or malfunction, install a pressure relief device downstream of the Filter/Regulator/Lubricators. The relief pressure and flow capacity of the relief device must satisfy the system requirements.

In lubrication applications, some oil mist may escape from the point of use into the surrounding atmosphere. Users are referred to OSHA Safety and Health Standards for Limiting Oil Mist Contamination and Utilization of Protecting Equipment. Through misuse, age, or malfunction, components used in fluid power systems can fail in various modes. The system designer is warned to consider the failure modes of all component parts used in the fluid power systems and to provide adequate safeguards to prevent personal injury or damage to equipment in the event of such failure modes.

**System designers must provide a warning to end users in the system instruction manual if protection against a failure mode cannot be adequately provided.**

System designers and end users are cautioned to review specific warnings found in the instruction sheets packed and shipped with these products.

---

## *CONTROL VALVE PRODUCTS*

These products are intended for use in industrial compressed air systems only. They must not be used where pressures and temperatures can exceed those listed under Specification.

Before using these products with fluids other than those specified, for nonindustrial applications, life-support systems, or other applications not within published specifications, consult Boston Gear.

Through misuse, age, or malfunction, components used in fluid power systems can fail in various modes. The system designer is warned to consider the failure modes of all component parts used in the fluid power systems and to provide adequate safeguards to prevent personal injury or damage to equipment in the event of such failure modes. **System designers must provide a warning to end users in the system instruction manual if protection against a failure mode cannot be adequately provided.**

System designers and end users are cautioned to review specific warnings found in the instruction sheets packed and shipped with these products. System designers should also provide for all OSHA requirements including Title 29 CFR 1910.147 Lockout/Tagout.