

Product Selection / Reference Guide

800B Series In-Line Helical Gear Non-Flanged Input

Selection Pages 176-185



**Double Reduction
Foot Mounted**
Dimensions-Page 190



**Triple Reduction
Foot Mounted**
Dimensions-Page 191



**Double Reduction
Output Flange Mount**
Dimensions-Page 192



**Triple Reduction
Output Flange Mount**
Dimensions-Page 193

800B Series Helical Worm Gear Reducer

Selection Pages 207-221



Double Reduction Flange
Dimensions-Page 232



Triple Reduction Flange
Dimensions-Page 233



**Double Reduction
Non-Flange**
Dimensions-Page 234



**Triple Reduction
Non-Flange**
Dimensions-Page 235

F600B Series Helical Gear Flanged Input

Selection Pages 278-295



**Single Reduction
Foot Mounted, Flange Input**
Dimensions - Page 297



**Double & Triple Reduction
Foot Mounted, Flange Input**
Dimensions - Page 298

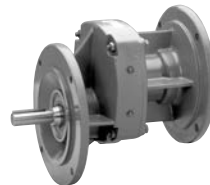

**Single Reduction
Output Flange Mounted**
Dimensions - Page 299



**Double & Triple Reduction
Output Flange Mounted**
Dimensions - Page 300

600B Series Helical Gear Non-Flanged Input

Selection Pages 278-295



**Single Reduction
Foot Mounted**
Dimensions - Page 301



**Double & Triple Reduction
Foot Mounted**
Dimensions - Page 302

Right-90 Series Spiral Bevel



Right-90 Series
Pages 305-308

R100/R200 VR100/VR200 Series Spiral Bevel



R100/R200 Series
Horizontal Base Model
Dimensions-Page 313



VR100/VR200 Series
Vertical Base Model
Dimensions-Page 313

R1000 Series Straight Bevel



R1000 Series
Pages 316-327

Motors and Brakes



**NEMA C-Face
AC-Motors**
Pages 334-339



**NEMA C-Face
DC Motors**
Pages 340-341



BostKleen™ / Stainless
Pages 342



**Double C-Face AC Brakes
CMBA Series**
Pages 343

