

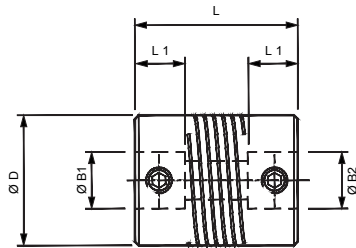

Multi-Beam

Stainless Steel Multi-Helix Flexible 3 Beam Couplings - Non-Relieved

Set Screw Hubs



Clamp Hubs

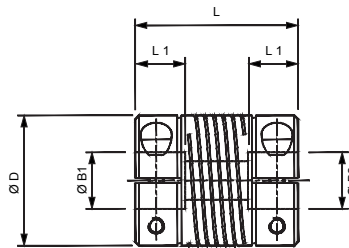

Materials & Finishes

Couplings: Stainless Steel 303 S31

Fasteners: Stainless Steel

Temperature Range

-40°F to +284°F
(-40°C to +140°C)

NON-CATALOG ITEM

3-BEAM COUPLINGS: DIMENSIONS & ORDER CODES

Coupling Type & Size	Set Screw Style	Clamp Type	ØD in. (mm)	L in. (mm)	L1 in. (mm)	Bore Diameters			Mass kgx10 ⁻³	Fasteners				Angular Offset Deg.	Parallel Offset mm	Torsional Stiffness Nm/rad	Peak Torque lb.in (Nm)
						Min B1	Min B2	Max B1 & B2		Set Screw	Cap Screw	Torque lbs.-in. (Nm)	Wrench in. (mm)				
Non-Relieved	9	700.09	-.37 (9.5)	.56 (14.2)	.18 (4.5)	2.0	3.18	4.76	5.85	M2.5	-	2.04 (0.23)	.051 (1.3)	3	.004 (0.1)	16	4.43 (0.50)
		-	701.09							-	M1.6	1.33 (0.15)	.059 (1.5)				
	13	700.13	-.5 (12.7)	.75 (19.1)	.24 (6.0)	3.0	4.76	6.35	13.7	M3	-	2.83 (0.32)	.059 (1.5)	5	.005 (.127)	54	8.85 (1.0)
		-	701.13							-	M2	2.66 (0.30)	.059 (1.5)				
	16	700.16	-.63 (15.9)	.80 (20.3)	.26 (6.5)	3.0	5.0	8.0	22.9	M4	-	9.29 (1.05)	.079 (2.0)	5	.005 (.127)	81	15.9 (1.80)
		-	701.16							-	M2.5	6.02 (0.68)	.079 (2.0)				
	19	700.19	-.75 (19.1)	.90 (22.9)	.26 (6.5)	4.0	6.0	10.0	35.9	M4	-	9.29 (1.05)	.079 (2.0)	5	.005 (.127)	143	23.9 (2.70)
		-	701.19							-	M2.5	6.02 (0.68)	.079 (2.0)				
	25	700.25	-1.0 (25.4)	1.25 (31.8)	.35 (9.0)	5.0	8.0	12.7	92.2	M5	-	18.6 (2.10)	.098 (2.5)	5	.005 (.127)	175	53.1 (6.0)
		-	701.25							-	M3	10.6 (1.20)	.098 (2.5)				
	32	700.32	-1.25 (31.8)	1.75 (44.5)	.47 (12.0)	6.0	9.53	16	194	M6	-	33.2 (3.75)	0.12 (3.0)	5	.005 (.127)	378	88.5 (10.0)
		-	701.32							-	M4	25.2 (2.85)	0.12 (3.0)				

① Length of supported bore.

③ **Peak torque.** Select a size where Peak Torque exceeds the application torque x service factor. (See main catalog, P-7293-HD, page 4)

② Max. compensation values are mutually exclusive.

BORE SIZES 3-BEAM COUPLINGS - NON-RELIEVED

Sizes indicated in parenthesis are metric (mm).

Coupling Size	ØB1, ØB2 +0.0012/-0 (+0.03mm/-0mm)																		
	(1)	(2)	(3)	1/8"	(4)	3/16"	(5)	(6)	1/4"	(8)	3/8"	(10)	(12)	1/2"	(14)	(15)	5/8"	(16)	
9		○	○	●	●	●													
13			○	○	○	●	●	●	●										
16			○	○	○	○	●	●	●	●									
19					○	○	○	●	●	●	●	●							
25						○	○	○	○	○	●	●	●	●					
32							○	○	○	○	○	●	●	●	●	●	●	●	●
Bore ref.	8	11	14	16	18	19	20	22	24	28	31	32	35	36	38	40	41	42	

○ B1 only ● B1 & B2



An Altra Industrial Motion Company

www.huco.com

440 North Fifth Avenue
Chambersburg, PA 17201 - USA
888-829-6637
Fax: 717-264-6420

Merchant Drive, Hertford
Hertfordshire, SG13 7BL - England
+44 (0)1992 501900
Fax: +44 (0)1992 509890