



Turboflex Plus
High
Performance
Disc Coupling

 **AMERIDRIVES™**
A REGAL REXNORD BRAND

 **BIBBY TURBOFLEX™**
A REGAL REXNORD BRAND

REGAL REXNORD HIGH PERFORMANCE DISC COUPLINGS

Two leading international flexible coupling manufacturers, Ameridrives® International and Bibby Turboflex introduce a new series of high performance disc couplings designed to meet the stringent requirements of today's turbomachinery market. The Turboflex Plus combines the proven Turboflex and Ameridisc disc couplings together with the experience of the Ameriflex diaphragm producing a coupling as ideally suited to sensitive high speed turbocompressors as it is to low speed load couplings whilst offering an economical solution and being fully compliant API-671/ISO10441 for critical oil and gas, energy, and petrochemical applications. Ameridrives and Bibby Turboflex Couplings are selected where quality and reliability are essential to the operation of a plant.



COMPANY HISTORY

Ameridrives Couplings, originally established in 1928 as the Mechanical Drives Division of Zurn Industries, has pioneered many coupling designs throughout the years. Introduced in 1972, the Ameriflex multiple, convoluted, diaphragm couplings is still considered the world's best high performance flexible coupling.

Bibby Turboflex was originally established in 1917 under the direction of Dr. James Bibby, inventor of the resilient grid coupling, and has since been a market leader in flexible couplings. The Turboflex profiled disc coupling was first introduced to the high performance market in 1958 and today has tens of thousands of couplings in operation.

www.Ameridrives.com www.BibbyTurboflex.com

Turboflex Plus FEATURES AND ADVANTAGES:

- Scalloped profile disc pack optimized for high speed compressor applications
- Cost reduced, economical solution for today's turbomachinery market
- Fully compliant to API-671/ISO10441
- Disc material – 300 series stainless, Inconel option
- Coated or uncoated discs
- Phosphate coating standard on components
- Shrouded fasteners for reduced windage

Turboflex Plus COUPLING DESIGNS



Series MS

Marine Style

- Largest bore capacity
- Integral flange designs available
- High torque design
- Factory assembled center section simplifies installation
- Standard anti-flail system for increased safety
- Optional windage designs available

Typical Applications

- Marine drives
- Power Generation
- Turbine to Gearbox/Compressor



Series RH

Reduced Moment

- Reverse Hub
- Low overhung moment
- Large bore capacity
- High torque design
- Standard reduced windage design

Typical Applications

- High speed compressor applications where low overhung mass is required
- Refining / Petrochemical processes



Series RM

Reduced Moment

- Lowest overhung moment
- Large bore capacity
- High torque design
- Standard reduced windage design
- Co-planar design for increased momentary torque overload protection

Typical Applications

- Critical high speed compressor applications where minimal overhung moment is the primary design driver
- Refining / Petrochemical processes

Turboflex Plus IS DESIGNED WITH OVERLOAD PROTECTION FEATURES TO LIMIT SECONDARY DAMAGE IN THE EVENT OF A DISC PACK FAILURE

In either design, machinery vibration will increase but the drive will be maintained sufficiently for the unit to be shut down.

Marine Style



Standard on the MS series, the interlocking flange arrangement utilizes the fasteners in clearance holes to allow components to shift slightly in the event of a disc pack failure and act as a simple pin & bush coupling.

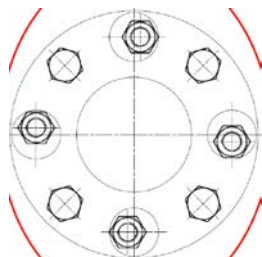
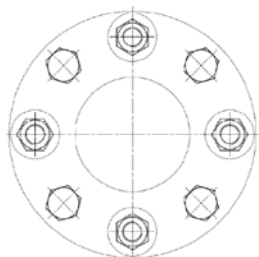

Series RM

Reduced Moment



An optional coplanar design is used as a back-up drive to prevent steam turbine "runaway" and as a temporary fail-safe device to limit secondary damage. This design also offers the lowest overhung moment for laterally sensitive compressors.

Ameridrives Facilities

North America

USA

1802 Pittsburgh Avenue
Erie, PA 16502 - USA
814-480-5000

*Mill Spindles, Ameriflex, Ameridisc,
Universal Joints, Driveshafts,
Mill Gear Couplings*

2000 Clovis Barker Road
San Marcos, TX 78666 - USA
888-449-9439

*Gear Couplings, Small Industrial
Driveshafts*

300 Indiana Highway 212
Michigan City, IN 46360
219-874-5248

Irrigation Universal Driveshafts

Bibby Turboflex Facilities

Europe

United Kingdom

Bibby Turboflex, Unit 16
Victoria Spring Business Park
Wormald St, Liversedge
WF15 6RA - England.
+44(0) 1924 460801

*Disc, Gear, Grid Couplings,
Overload Clutches*



Scan to see all
the brands of
Regal Rexnord

Neither the accuracy nor completeness of the information contained in this publication is guaranteed by the company and may be subject to change in its sole discretion. The operating and performance characteristics of these products may vary depending on the application, installation, operating conditions and environmental factors. The company's terms and conditions of sale can be viewed at <https://www.ameridrives.com/company/terms-and-conditions>. These terms and conditions apply to any person who may buy, acquire or use a product referred to herein, including any person who buys from a licensed distributor of these branded products.

©2023 by Ameridrives LLC. All rights reserved. All trademarks in this publication are the sole and exclusive property of Ameridrives LLC or one of its affiliated companies.

©2023 by Bibby Turboflex LLC. All rights reserved. All trademarks in this publication are the sole and exclusive property of Bibby Turboflex LLC or one of its affiliated companies.



www.ameridrives.com



www.bibbyturboflex.com