

# AVS Series Rigid Couplings

Installation Instructions

P-5030-TBW

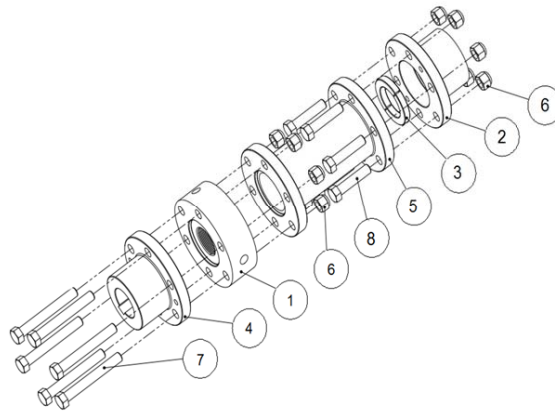

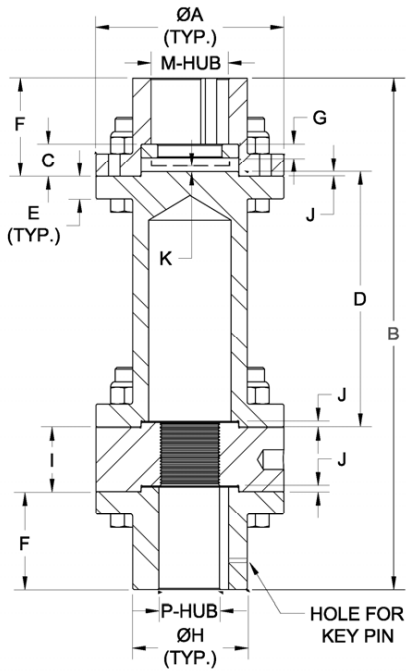

ITEM	DESCRIPTION
1	Adjusting Nut (2)
2	Motor Hub
3	Split Ring
4	Pump Hub
5	Spacer
6	All Steel Lock Nut
7	Pump End Bolt
8	Motor End Bolt

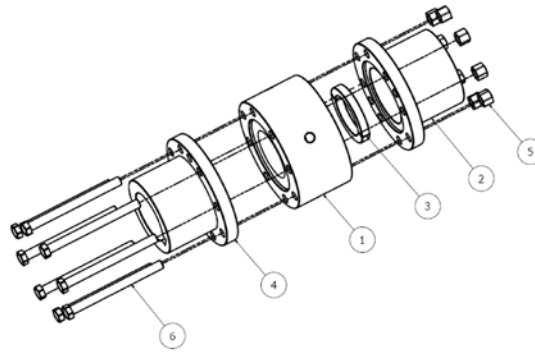
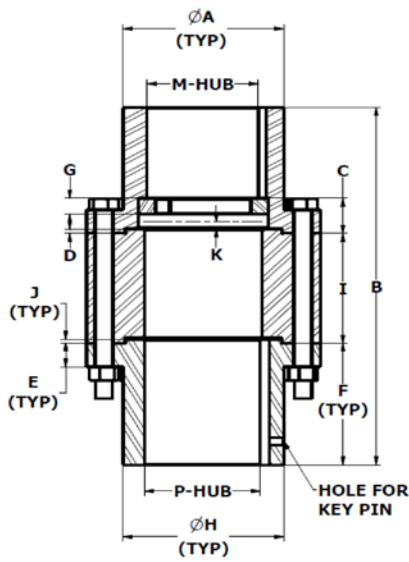

ITEM	DESCRIPTION
1	Adjusting Nut (2)
2	Motor Hub
3	Split Ring
4	Pump Hub
5	All Steel Lock Nut
6	Pump End Bolt

LINESHAFT DIAMETER	HEADSHAFT NUT THREAD/INCH	INCHES PER FULL TURN OF ADJ. NUT
1.00"	14 TPI - RH/LH	.071
1.25"	12 TPI - RH/LH	.083
1.50"	12 TPI - RH/LH	.083
1.6875"	10 TPI - RH/LH	.100
1.9375"	12 TPI - RH/LH	.083
2.25"	12 TPI - RH/LH	.083
2.4375"	12 TPI - RH/LH	.083

COUPLING SIZE	DISC BOLT THREAD SIZE	NUT TORQUE (FT-LB)
114	1/4-20	12
134	5/16-18	25
214	1/2-13	106
234	1/2-13	106
318	1/2-13	106
338	1/2-13	106
414	3/4-10	376
512	1-8	909
612	1-8	909
778	1-8	909
918	1 1/8-7	1288
1100	1 1/8-7	1288

### ASSEMBLY & ALIGNMENT

- 1) Clean driver mounting flange on discharge head and head shaft threads, remove any nicks or burrs and lubricate with oil.
- 2) Install driver hub on driver shaft:
  - Insert key into keyway, making sure key clears the circular groove cut around the shaft near the end.
  - Slide driver hub onto shaft far enough to insert the circular split ring into the shaft groove.
  - Install split ring in shaft groove and let driver hub slip down over the split ring and hold it in position.
- 3) Install pump hub on head shaft:
  - Slide pump hub onto shaft.
  - Insert key into keyway, making sure key clears the head shaft threads.
  - Thread adjusting nut onto shaft until top of adjusting nut is even with end of shaft.
- 4) If using spacer type coupling, bolt the spacer to the driver hub.
- 5) Turn the adjuster nut until proper impeller adjustment is achieved per pump manufacturer guidelines.
  - Adjusting Nut has holes on outside to allow for inserting hex wrench or round bar to facilitate adjustment.
- 6) Bolt pump hub and adjuster nut to spacer or driver hub and tighten to specified torque.

### HUB SHRINK FIT TEMPERATURES

DATA SUPPLIED FOR REFERENCE ONLY! Installer must ensure that proper procedures and values are used. Graph assumes steel hub material and 70° F. ambient temperature, and includes a 10% safety margin. For example, for 6" bore and .008" interference, heating the hub from 70° to 300° will expand the hub by .008". Do not exceed the interference specified on the assembly drawing to avoid overstressing the hub.

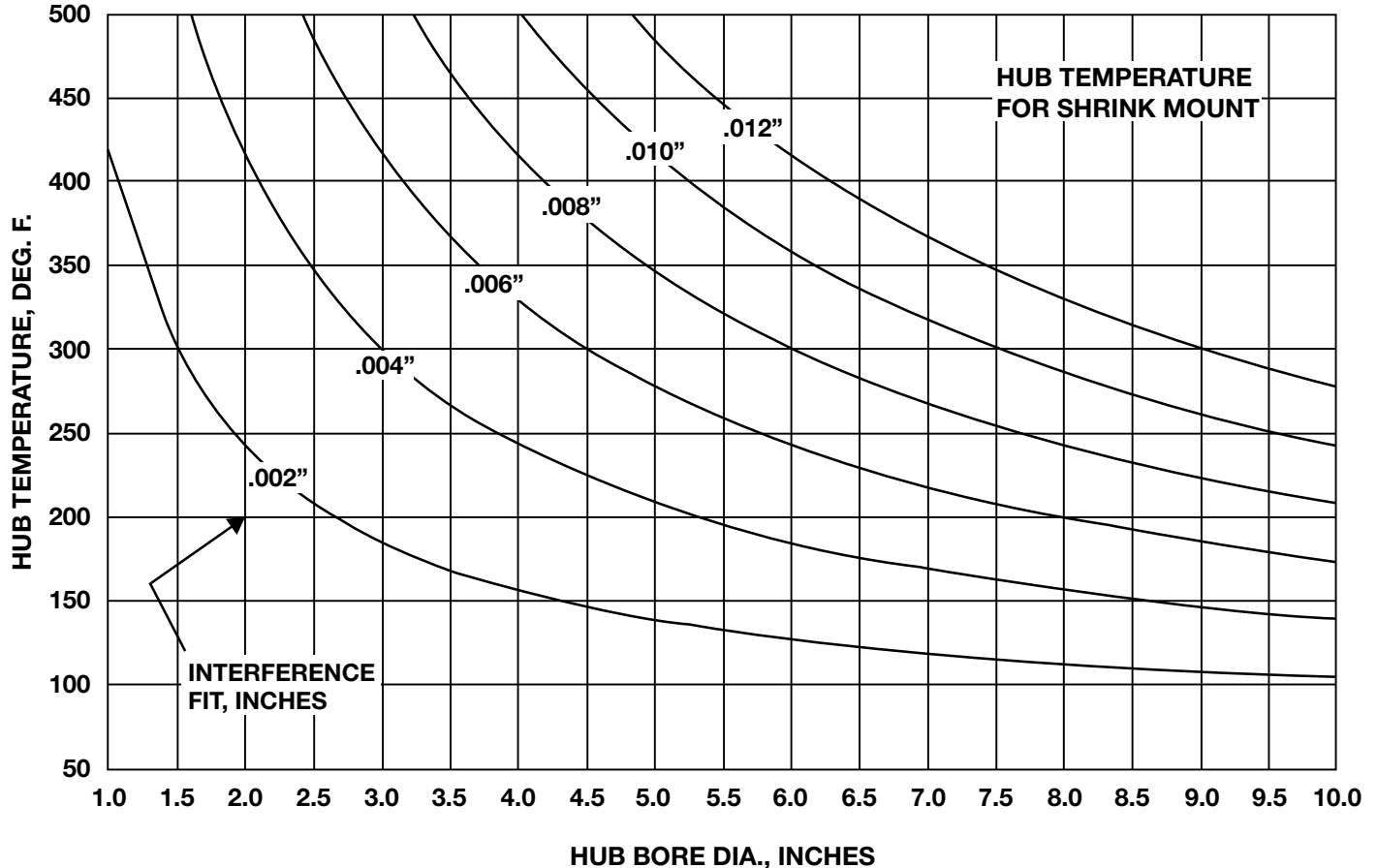

## TB Wood's Facilities

### North America

#### USA

440 North Fifth Avenue  
Chambersburg, PA 17201 - USA  
888-829-6637 \* 717-264-7161

*Belted Drives and Elastomeric Couplings*

#### Customer Service

1-888-829-6637 (Press #5)

#### For Application Support

1-888-829-6637 (Press #7)

2000 Clovis Barker Road  
San Marcos, TX 78666 - USA  
1-888-449-9439

*General Purpose Disc Couplings*

#### Customer Service

1-888-449-9439

4970 Joule St  
Reno, NV 89502 - USA  
775-857-1800

#### Canada

9779 45 Ave NW  
Edmonton, AB T6E 5V8 - Canada  
+1 780-439-7979

6305 Danville Road  
Mississauga, ON L5T 2H7 - Canada  
1-800-829-6631

1073 Rue Bégin  
Saint-Laurent, QC H4R 1V8 - Canada  
+1 514-332-4812

#### Mexico

Comisión Federal de Electricidad 850,  
Industrial San Luis,  
San Luis, S.L.P., 78395 - Mexico  
+52 444 137 1500

### Europe

Merchant Drive, Hertford  
Hertfordshire SG13 7BL - England  
+44(0)1992 501900  
*Elastomeric Couplings*

## The Brands of Altra Motion

### Couplings

**Ameridrives**  
[www.ameridrives.com](http://www.ameridrives.com)

**Bibby Turboflex**  
[www.bibbyturboflex.com](http://www.bibbyturboflex.com)

**Guardian Couplings**  
[www.guardiancouplings.com](http://www.guardiancouplings.com)

**Huco**  
[www.huco.com](http://www.huco.com)

**Lamiflex Couplings**  
[www.lamiflexcouplings.com](http://www.lamiflexcouplings.com)

**Stromag**  
[www.stromag.com](http://www.stromag.com)

**TB Wood's**  
[www.tbwoods.com](http://www.tbwoods.com)

### Linear Systems

**Thomson**  
[www.thomsonlinear.com](http://www.thomsonlinear.com)

**Warner Linear**  
[www.warnerlinear.com](http://www.warnerlinear.com)

### Geared Cam Limit Switches

**Stromag**  
[www.stromag.com](http://www.stromag.com)

### Engineered Bearing Assemblies

**Kilian**  
[www.kilianbearings.com](http://www.kilianbearings.com)

### Electric Clutches & Brakes

**Matrix**  
[www.matrix-international.com](http://www.matrix-international.com)

**Stromag**  
[www.stromag.com](http://www.stromag.com)

**Warner Electric**  
[www.warnerelectric.com](http://www.warnerelectric.com)

**Deltran**  
[www.thomsonlinear.com](http://www.thomsonlinear.com)

### Belted Drives

**TB Wood's**  
[www.tbwoods.com](http://www.tbwoods.com)

### Heavy Duty Clutches & Brakes

**Twiflex**  
[www.twiflex.com](http://www.twiflex.com)

**Stromag**  
[www.stromag.com](http://www.stromag.com)

**Svendborg Brakes**  
[www.svendborg-brakes.com](http://www.svendborg-brakes.com)

**Wichita Clutch**  
[www.wichitaclutch.com](http://www.wichitaclutch.com)

### Gearing & Specialty Components

**Bauer Gear Motor**  
[www.bauergears.com](http://www.bauergears.com)

**Boston Gear**  
[www.bostongear.com](http://www.bostongear.com)

**Delevan**  
[www.delevan.com](http://www.delevan.com)

**Delroyd Worm Gear**  
[www.delroyd.com](http://www.delroyd.com)

**Nuttall Gear**  
[www.nuttallgear.com](http://www.nuttallgear.com)

### Engine Braking Systems

**Jacobs Vehicle Systems**  
[www.jacobsvehiclesystems.com](http://www.jacobsvehiclesystems.com)

### Precision Motors & Automation

**Kollmorgen**  
[www.kollmorgen.com](http://www.kollmorgen.com)

### Miniature Motors

**Portescap**  
[www.portescap.com](http://www.portescap.com)

### Overrunning Clutches

**Formsprag Clutch**  
[www.formsprag.com](http://www.formsprag.com)

**Marland Clutch**  
[www.marland.com](http://www.marland.com)

**Stieber**  
[www.stieberclutch.com](http://www.stieberclutch.com)

Neither the accuracy nor completeness of the information contained in this publication is guaranteed by the company and may be subject to change in its sole discretion. The operating and performance characteristics of these products may vary depending on the application, installation, operating conditions and environmental factors. The company's terms and conditions of sale can be viewed at <http://www.altramotion.com/terms-and-conditions/sales-terms-and-conditions>. These terms and conditions apply to any person who may buy, acquire or use a product referred to herein, including any person who buys from a licensed distributor of these branded products.

©2019 by TB Wood's LLC. All rights reserved. All trademarks in this publication are the sole and exclusive property of TB Wood's LLC or one of its affiliated companies.



[www.tbwoods.com](http://www.tbwoods.com)

2000 Clovis Barker Road  
San Marcos, TX 78666  
512-353-4000