

PC Series Clutch

PC-1225 Normal Duty

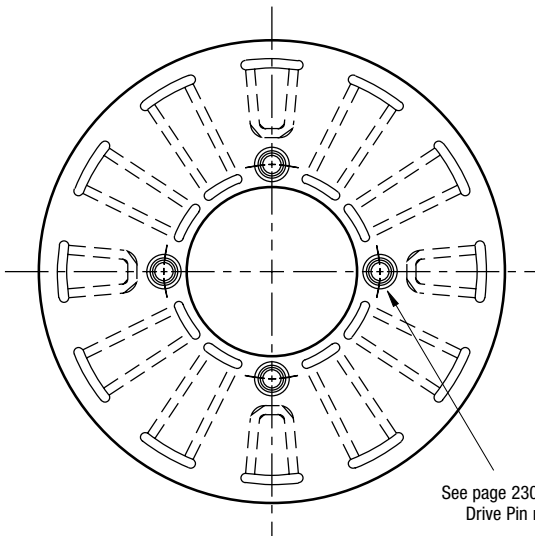

ARMATURE VIEW

See page 230 for details on Drive Pin mountings.

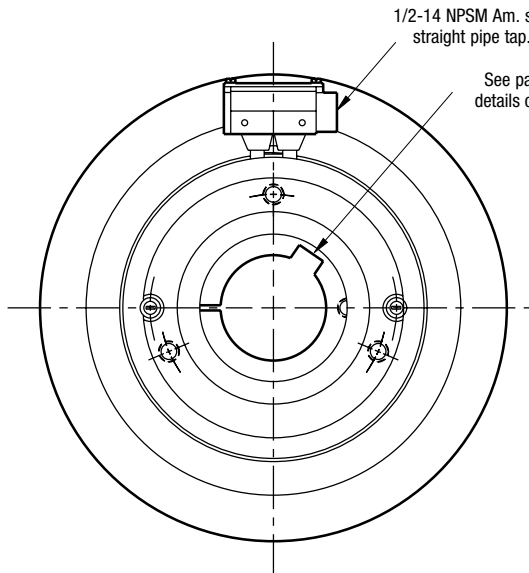

COLLECTOR RING VIEW

1/2-14 NPSM Am. std. straight pipe tap.

See page 252 for details on Bushings.

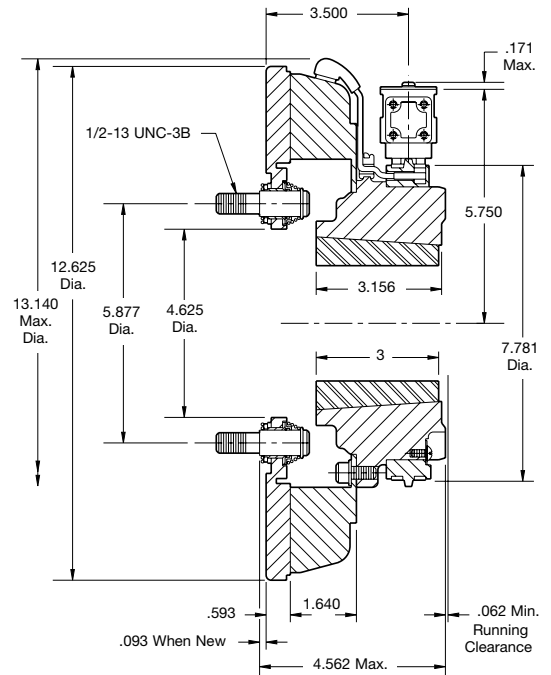

| | |
|------------------|----------------|
| Shaft Size | .937 – 3.000 |
| Static Torque | 465 lb.ft. |
| Maximum Speed | 3,000 rpm |
| Standard Voltage | D.C. 6, 24, 90 |

All dimensions are nominal unless otherwise noted.

Information on inertia and weights begins on page 239. Coil data is on pages 250 and 251.



Drawing I-25602

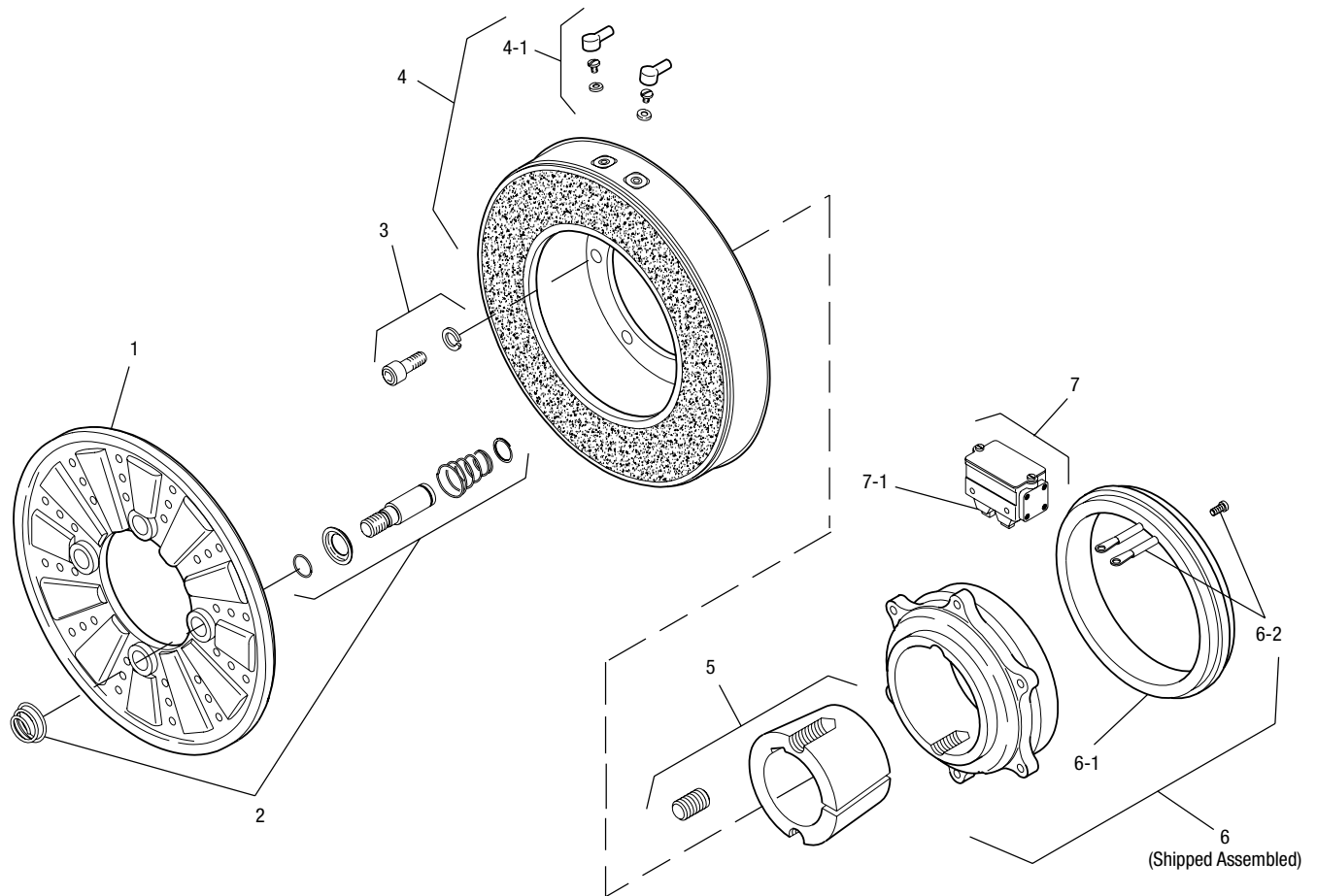

| Item | Description | Part Number | Qty. |
|------|--------------------------|----------------------|------|
| 1 | Armature | 5303-111-009 | 1 |
| 2 | Autogap Accessory | 5201-101-008 | 4 |
| 3 | Mounting Accessory | 5321-101-001 | 1 |
| 4 | Magnet | | 1 |
| | 6 Volt | 5303-631-005 | |
| | 24 Volt | 5303-631-007 | |
| | 90 Volt | 5303-631-008 | |
| | †90 Volt LK Facing | 5303-631-001 | |
| 4-1 | Terminal Accessory | 5311-101-001 | 1 |
| 5 | Bushing* | | 1 |
| | 15/16" to 3" Bore | 180-0262 to 180-0295 | |
| 6 | Magnet Hub | | 1 |
| | Left Hand (shown) | 5303-541-001 | |
| | Right Hand | 5303-541-002 | |
| 6-1 | Collector Ring | 5301-749-001 | 1 |
| 6-2 | Collector Ring Accessory | 5303-101-004 | 1 |

| Item | Description | Part Number | Qty. |
|------|-------------|--------------|------|
| 7 | Brushholder | 5300-178-001 | 1 |
| 7-1 | Brush | 176-0001 | 4 |

How to Order:

1. Specify Voltage for Item 4.
2. Specify Bore Size for Item 5.
3. Specify left hand or right hand hub for Item 6. (Bushing enters from magnet side for L.H. hub and from hub side for R.H.)
4. See Controls Section.

Example:

PC-1225 Clutch per I-25602 - 90 Volt, L.H. hub, 1" Bore

These units meet standards set forth in UL508 and are listed under guide card #NMTR2, file #59164.

These units are CSA certified under file #LR11543

*See page 252 for specific part numbers.

Refer to Service Manual P-0207-WE

†Optional LK facing available. For more information, see page 232.