

## Electro-Magnetic Toothed Brake

### Characteristics

- Electrically operated 24 or 103,5 VDC, depending on size
- Toothed operated brake
- Activated by power on

### Utilisation

- Braking of a pulley or a hub in position
- Braking has to be made at standstill or at very low speed, in case of doubt consult the factory
- For wet or dry operation

### Particularities

- Positive braking for drive without slipping
- Standard available for random operation
- Option : detection disc allows the braking position to be validated, see dimensions page 47

### Adjustments

- Verify position of tooth "J" prior to installation
- No wear adjustment required

### Maintenance Manual

- SM 316

### Mounting Precautions

- Device intended for horizontal or vertical use

### Power Supply

- For sizes until 3200  
CBC 400-24, CBC 450-24,  
CBC 140 -5 + CBC 140-T (24V)
- For sizes 6400, and 12800  
CBC 140 -5 (103,5V)

### Mounting Example

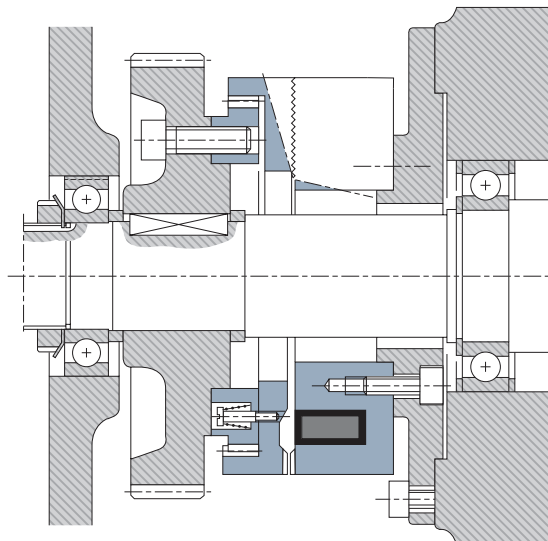

## Electro-Magnetic Toothed Brake

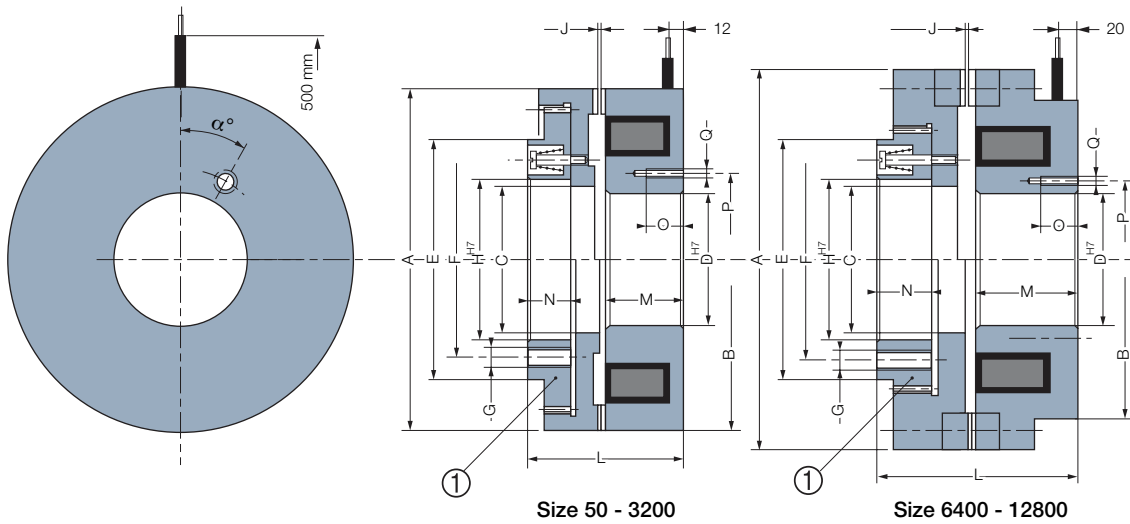

Sizes		50	100	200	400	800	1600	3200	6400	12800
<b>Nom. Torque</b>	[Nm]	50	100	200	400	800	1600	3200	6400	12800
<b>Max. Speed</b>	[min. <sup>-1</sup> ]	5000	4300	3600	3300	2700	2100	1800	1500	1500
<b>Voltage</b>	[VDC]	24	24	24	24	24	24	24	103,5	103,5
<b>Power</b>	P20 [W]	22	26	33	33	47	68	79	111	143
	A	75	90	105	115	140	185	215	320	385
	B	75	90	105	115	140	185	215	260	315
	C	40	49,5	58	63	76	99	117	153	180
	D	35	42	50	55	65	85	105	140	175
	E	65,5	75,5	85,5	100,5	115,5	155,5	180,5	215,5	275,5
	F	55	64	75	85	100	135	155	190	250
	G	4xM5	4xM5	4xM6	6xM6	6xM8	6xM10	6xM10	12xM12	12xM116
	H	45	53	65	70	85	115	130	153	190
	J	0,4	0,5	0,5	0,5	0,6	0,7	0,9	1	1
	L	38	40	44	48	65	80	100	143	165
	M	23	22,3	23,7	26,2	36,9	44	52	82,3	92,6
	N	8	10	12	12,5	17	21	28	35	41
	O	9	9	10	13	17	19	20	26	30
	P	45	50	65	70	80	110	135	170	210
	Q	6xM5	6xM5	6xM6	6xM8	6xM10	6xM12	10xM12	10xM16	12xM18
	$\alpha$	30°	30°	30°	30°	30°	30°	18°	18°	15°
<b>Inertia</b>	① [kgm <sup>2</sup> ]	0,0002	0,0006	0,001	0,002	0,030	0,030	0,055	0,406	1,08
<b>Weight</b>	[kg]	0,8	1,25	1,8	2,5	5	11	22	54	90
<b>Connection</b>		<b>Leads</b>				<b>Cable</b>				

### Connector Options

(Delivered without cable)

2 poles, capacity : 0,5/2,5mm<sup>2</sup>

