

Heavy Duty Spacer Coupling GCF Series - Form-Flex®

Double Flex Spacer

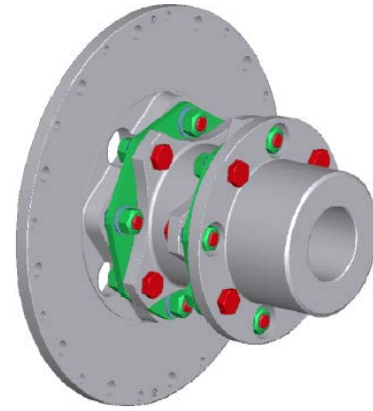
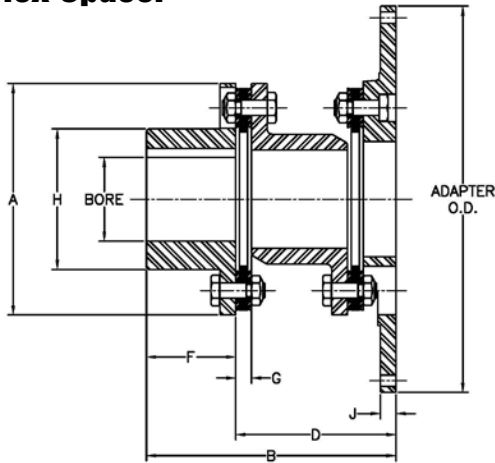

Size	Spacer	Max Bore		Dimensions (in)							Adapter O.D. / Standard Bolt Pattern							
		(in)	(mm)	A	B	D	F	G	H	J	Size	12.375	13.875	18.375	20.375	22.500	26.500	28.875
340	31	3.75	100	8.38	8.19	5.31	2.88	0.57	5.44	0.5	340	12	14	18	20	22	26	28
	8.76				5.88	Order						SAE	SAE	Order	SAE			
412	42	4.50	120	11.00	11.39	7.14	4.25	0.75	6.51	0.57	412			SAE	Order	SAE	SAE/HD	SAE/HD
	45				11.89	7.64					424			SAE/HD	Order	SAE/HD	SAE/HD	SAE/HD
	50				13.01	8.76					456					SAE/HD	SAE/HD	SAE/HD
424	55	6.88	190	15.00	16.14	9.89	6.25	0.98	9.57	1.00	511					SAE/HD	SAE/HD	
	60				17.14	10.89												
456	70	8.00	220	18.00	19.69	12.44	7.25	1.32	11.63	1.13	SAE Bolting							
	75				20.76	13.51					BC	11.625	13.125	17.25	19.25	21.375	25.25	27.25
511	80	10.00	280	22.00	23.76	14.76	9.00	1.56	14.5	1.38	Hole Qty	8	8	8	8	6	12	12
	85				24.76	15.76					Hole Dia	0.41	0.41	0.53	0.53	0.65	0.65	0.78
	92				26.26	17.26					HD Bolting							
											BC	11.5	12.5	16.75	18.5	20.5	24.5	26.875
											Hole Qty	8	8	8	8	8	12	12
											Hole Dia	0.53	0.65	0.78	0.91	1.03	1.03	1.03
											Speed Limit by Adapter O.D. (2b)							
											RPM	3,400	3,400	2,900	2,600	2,400	2,000	1,800

Size	Spacer	Rated Torque		Peak Overload	Max RPM (2a)	Weight (1)	WR ² (1)	Misalignment Capacity			
		HP/100 RPM	(lb-in)					(lb-in)	Axial (+/- in)	Angular (Degrees/Disc Pack)	
340	31	64	40,000	60,000	3,400	46	567	0.06	0.33°		
	35									47	572
412	42	190	120,000	180,000	2,500	127	3,267	0.08			
	45									129	3,281
	50									132	3,312
424	55	380	240,000	360,000	1,800	261	8,346	0.10			
	60									268	8,464
456	70	889	560,000	840,000	1,500	491	22,549	0.12			
	75									502	22,825
511	80	1,746	1,100,000	1,650,000	1,200	870	58,863	0.14			
	85								885	59,503	
	92								1014	68,905	

- 1) Weight and WR2 calculated with hub at maximum inch bore size and minimum available adapter size.
- 2) a) Max RPM shown for smallest available adapter size, do not exceed this speed for any given coupling size.
b) Verify that adapter speed limit is adequate for application speed, do not exceed coupling MAX RPM (See note 2a).
- 3) Flywheel mounting hardware is not supplied with coupling.
- 4) Consult factory for torsional stiffness and alternating torque limits.

ORDERING

- 1) Specify coupling size and spacer option
Example: GCF424-60
- 2) Specify adapter size code. Specify bolting pattern for items noted as drilled per order.
Example: GCF424-60-26 or GCF424-60-22HD
- 3) Specify hub bore size and tolerance, keyway size or keyless, special hub length, etc.

STANDARD MATERIALS

HUB - CARBON STEEL
 SPACER - DUCTILE IRON
 FLYWHEEL ADAPTER - DUCTILE IRON
 HARDWARE - ALLOY STEEL
 DISC PACKS - HIGH CARBON STEEL