

# Heavy Duty Spacer Coupling GCH Series - Form-Flex®

## Double Flex Spacer

| Size | Spacer | Max Bore |      | Dimensions (in) |       |       |      |      |       |
|------|--------|----------|------|-----------------|-------|-------|------|------|-------|
|      |        | (in)     | (mm) | A               | B     | D     | F    | G    | H     |
| 340  | 31     | 3.75     | 100  | 8.38            | 9.89  | 4.14  | 2.88 | 0.57 | 5.44  |
|      | 35     |          |      |                 | 10.46 | 4.71  |      |      |       |
| 412  | 42     | 4.50     | 120  | 11.00           | 14.07 | 5.57  | 4.25 | 0.75 | 6.51  |
|      | 45     |          |      |                 | 14.57 | 6.07  |      |      |       |
|      | 50     |          |      |                 | 15.69 | 7.19  |      |      |       |
| 424  | 55     | 6.88     | 190  | 15.00           | 19.95 | 7.45  | 6.25 | 0.98 | 9.57  |
|      | 60     |          |      |                 | 20.95 | 8.45  |      |      |       |
| 456  | 70     | 8.00     | 220  | 18.00           | 24.13 | 9.63  | 7.25 | 1.32 | 11.63 |
|      | 75     |          |      |                 | 25.20 | 10.70 |      |      |       |
| 511  | 80     | 10.00    | 280  | 22.00           | 29.39 | 11.39 | 9.00 | 1.56 | 14.50 |
|      | 85     |          |      |                 | 30.39 | 12.39 |      |      |       |
|      | 92     |          |      |                 | 31.89 | 13.89 |      |      |       |

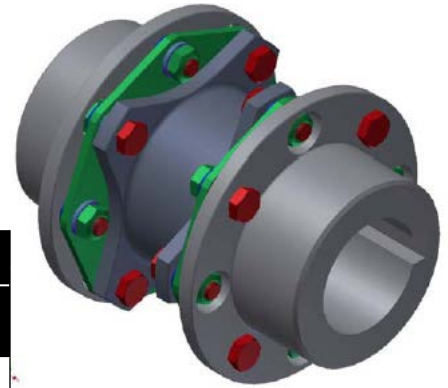
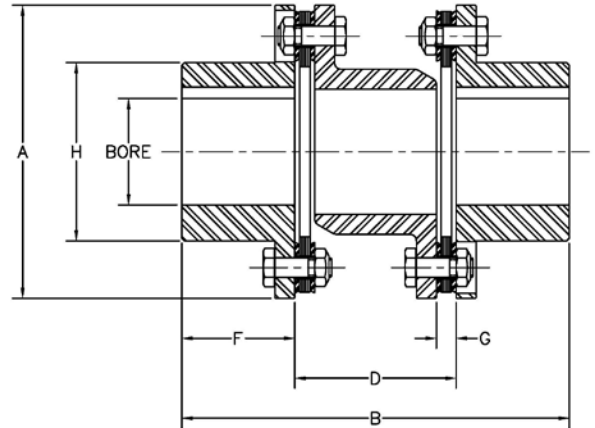

| Size | Spacer | Rated Torque |           | Peak Overload (lb-in) | Max RPM | Weight (1) (lbs) | WR <sup>2</sup> (1) (lb-in <sup>2</sup> ) | Misalignment Capacity |                             |
|------|--------|--------------|-----------|-----------------------|---------|------------------|---|-----------------------|-----------------------------|
|      |        | HP/100 RPM   | (lb-in)   |                       |         |                  |   | Axial +/- in          | Angular (Degrees/Disc Pack) |
| 340  | 31     | 64           | 40,000    | 60,000                | 3,400   | 43               | 344                                       | 0.06                  | 0.33°                       |
|      | 35     |              |           |                       |         | 44               | 349                                       |                       |                             |
| 412  | 42     | 190          | 120,000   | 180,000               | 2,500   | 106              | 1,371                                     | 0.08                  |                             |
|      | 45     |              |           |                       |         | 108              | 1,385                                     |                       |                             |
|      | 50     |              |           |                       |         | 112              | 1,416                                     |                       |                             |
| 424  | 55     | 380          | 240,000   | 360,000               | 1,800   | 278              | 7,141                                     | 0.10                  |                             |
|      | 60     |              |           |                       |         | 284              | 7,259                                     |                       |                             |
| 456  | 70     | 889          | 560,000   | 840,000               | 1,500   | 527              | 19,517                                    | 0.12                  |                             |
|      | 75     |              |           |                       |         | 538              | 19,793                                    |                       |                             |
| 511  | 80     | 1,746        | 1,100,000 | 1,650,000             | 1,200   | 964              | 54,373                                    | 0.14                  |                             |
|      | 85     |              |           |                       |         | 980              | 55,013                                    |                       |                             |
|      | 92     |              |           |                       |         | 1,108            | 64,414                                    |                       |                             |

Note: Couplings available for torque capacity up to 1129815 Nm. Contact Altra Couplings engineering with application details for coupling selection.

### STANDARD MATERIALS

HUBS - CARBON STEEL

SPACER - DUCTILE IRON

HARDWARE - ALLOY STEEL

DISC PACKS - HIGH CARBON STEEL

### MATERIAL / FINISH OPTIONS

DISC PACKS - STAINLESS STEEL

ZINC PHOSPHATE COATING

ALLOY STEEL HUBS

STEEL SPACER

### NOTES:

- 1) Weight and WR<sup>2</sup> are calculated with hubs at maximum inch bore size.
- 2) Consult factory for torsional stiffness and alternating torque limits.

### ORDERING

GCH SERIES COUPLINGS ARE SOLD AS COMPLETE ASSEMBLIES

- 1) Specify coupling size and spacer option

Example: GCH424-60 5" x 6-1/4"

- 2) Specify hub bore size and tolerance, keyway size or keyless, special hub length, etc. Please specify for each hub.