

Gear Units with C-Adapter

SIMPLE AND FAST ADAPTATION
OF STANDARD MOTORS



COST EFFECTIVE INSTALLATION!

CHARACTERISTICS OF THE C-ADAPTER:

- Installation space optimised
- Adaptation of IEC standard motors
- Adaptation of NEMA standard motors
- Backlash free torque transmission between motor and gear unit
- Simple assembly and disassembly of the motors
- Protection enclosure IP 54 and IP 65
- According to ATEX standard
- Maintenance-free coupling

The simple and cost effective installation, the minor service necessity and the high efficiency reduce costs throughout the whole life of the drive. The C-adapter provides a cost effective and installation space optimised adaptation of standard IEC and NEMA motors.

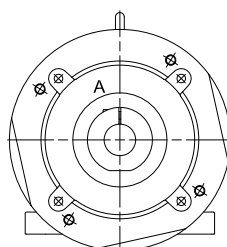

A (1:2)

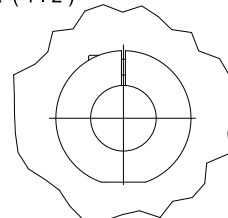

B (1:2)

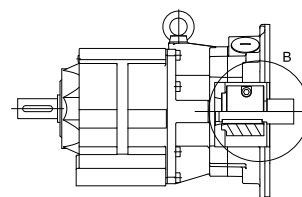
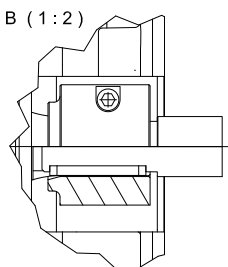

Cost Effective Installation!

Bauer Gear Motor supplies modern drive solutions for all industry sectors in which material must be moved.

Gear unit	Adaptable IEC motor sizes															Adaptable NEMA TC motor sizes									
Type	56	63	71	80	90	100	112	132	160	180	200	225	250	280	56C	143 145	182 184	213	215	254 256	284 286	324 326	364 365	404 405	
BG04	x																								
BG05	x	x																							
BG06	x	x	x	x											x										
BG10		x	x	x	x										x	x									
BG15		x	x	x	x										x	x									
BG20		x	x	x	x										x	x									
BG30		x	x	x	x	x	x								x	x	x	x							
BG40			x	x	x	x	x								x	x	x	x							
BG50			x	x	x	x	x	x	x						x	x	x	x	x	x					
BG60					x	x	x	x	x							x	x	x	x	x					
BG70					x	x	x	x	x	x	x	x	x	x		x	x	x	x	x	x	x	x	x	
BG80					x	x	x	x	x	x	x	x	x	x		x	x	x	x	x	x	x	x	x	
BG90						x	x	x	x	x	x	x	x	x					x	x	x	x	x	x	
BG100						x	x	x	x	x	x	x	x	x			x	x	x	x	x	x	x	x	
BF06		x	x	x											x										
BF10		x	x	x	x										x	x									
BF20		x	x	x	x										x	x									
BF30		x	x	x	x	x	x								x	x	x	x							
BF40			x	x	x	x	x								x	x	x	x							
BF50			x	x	x	x	x	x	x						x	x	x	x	x	x					
BF60					x	x	x	x	x							x	x	x	x	x					
BF70					x	x	x	x	x	x	x	x	x	x		x	x	x	x	x	x	x	x	x	
BF80					x	x	x	x	x	x	x	x	x	x		x	x	x	x	x	x	x	x	x	
BF90						x	x	x	x	x	x	x	x	x			x	x	x	x	x	x	x	x	
BK06	x	x	x	x											x										
BK10		x	x	x	x											x	x								
BK20		x	x	x	x											x	x								
BK30		x	x	x	x	x	x									x	x	x	x						
BK40			x	x	x	x	x									x	x	x	x						
BK50			x	x	x	x	x	x	x							x	x	x	x	x	x				
BK60					x	x	x	x	x								x	x	x	x	x				
BK70					x	x	x	x	x	x	x	x	x	x		x	x	x	x	x	x	x	x	x	
BK80					x	x	x	x	x	x	x	x	x	x		x	x	x	x	x	x	x	x	x	
BK90							x	x	x	x	x	x	x	x					x	x	x	x	x	x	
BS02	x	x																							
BS03		x	x	x												x									
BS04	x	x																							
BS06	x	x	x	x												x									
BS10		x	x	x	x											x	x								
BS20		x	x	x	x											x	x								
BS30		x	x	x	x	x	x									x	x	x	x						
BS40			x	x	x	x	x									x	x	x	x						
BM09		x	x	x												x									



BAUER GEAR MOTOR™

Regal Rexnord

bauergears.com | regalrexnord.com

The proper selection and application of products and components, including assuring that the product is safe for its intended use, are the responsibility of the customer. To view our Application Considerations, please visit <https://www.regalrexnord.com/Application-Considerations>.

To view our Standard Terms and Conditions of Sale, please visit <https://www.regalrexnord.com/Terms-and-Conditions-of-Sale>.

"Regal Rexnord" is not indicative of legal entity. Refer to product purchase documentation for the applicable legal entity. Regal Rexnord and Bauer Gear Motor are trademarks of Regal Rexnord Corporation or one of its affiliated companies.
© 2020, 2026 Regal Rexnord Corporation, All Rights Reserved. MCF-P-7105-BGM-EN-US 01/26

